

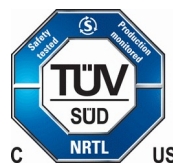

IER

ELECTRIC RESISTIVE STEAM HUMIDIFIER

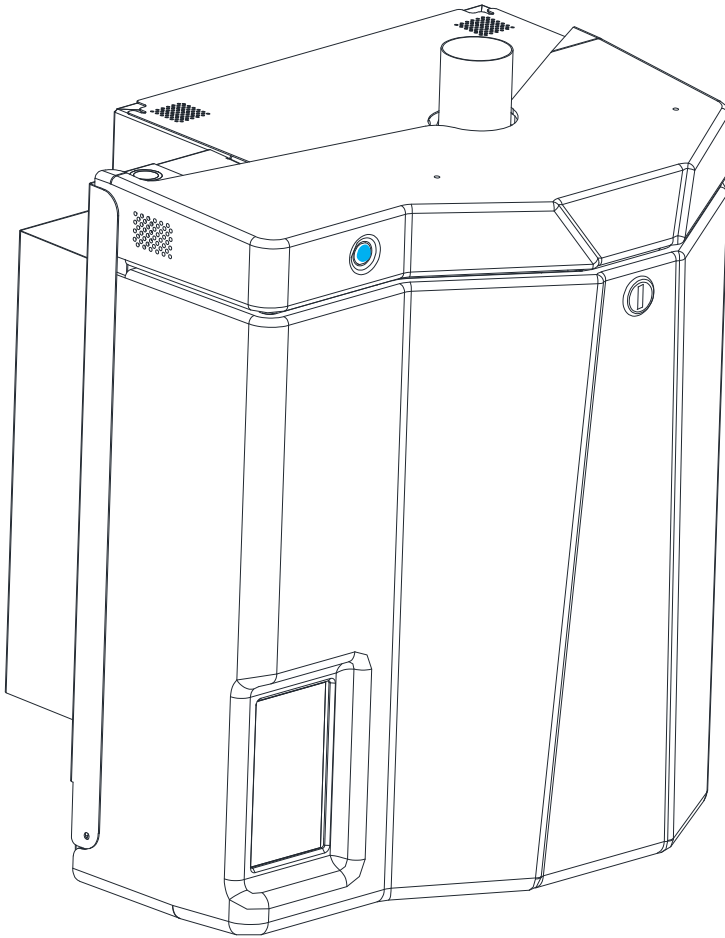

Installation and Operation Manual

Please read and save this manual

©steamOvap technologies inc, 1490 Mazurette, Montreal, Qc, H4N 1H2, Canada
Tel.: 1-844-357-4477 • www.steamOvap.com

Rev.: 210602

Introduction

Foreword

Thank you for purchasing IER steamOvap electric steam Humidifier.

If you have questions or comments please contact us:

www.steamOvap.com

info@steamOvap.com

1-844-357-4477

Intended use

IER electric steam humidifier is intended exclusively to produce steam from water at atmospheric pressure for air humidification.

Operating conditions are specified in this Installation and Operation Manual (IOM).

Operation of this humidifier in the intended use scope requires that all directions and information contained in this IOM are observed.

Any other use or operation outside the above design scope without written authorization from steamOvap may lead to trouble and hazardous conditions and will void warranty.

No alteration or modification to the humidifier must be done without written authorization from steamOvap.

Replacement of any defective components must be done with original component and spare parts from steamOvap representative.

Installation and Operation Manual Limitation

This IOM is intended for trained and qualified personnel and must be applied along with the applicable local codes and regulations.

Any work related to installation or service for this humidifier must comply with local code and regulation regarding safety and prevention of accidents.

End of life disposition

Ensure that **IER** electric steam humidifier is empty from water, if not proceed same way as for a standard drain for service.

Disconnect **IER** electric steam humidifier from power supply, electrical control signal, water main supply, Steam line, and drain. **IER** electric steam humidifier can then be removed from the wall or stand.

IER electric steam humidifier is an electrical equipment and as such **MUST** not be disposed of in domestic waste.

This humidifier should be returned to the closest steamOvap authorized representative for proper dismantling, recycling and disposition of components according to local regulations.

Table of content

Introduction.....	2
Table of content.....	3
EC Declaration of conformity.....	4
Safety warnings.....	5
Before to proceed to Installation.....	6
IER Overview.....	7
Installation overview.....	10
Installation – step 1 IER Positioning & Mounting.....	12
Installation – step 2 Water supply installation.....	17
Installation – step 3 Drain installation.....	19
Installation – step 4 Steam distribution installation.....	21
SR models for horizontal in duct humidification.....	21
SR models for Vertical duct - Option -V.....	22
SR models for round duct - Option -R.....	22
SOS or SOE – steamOsorb, multi-ramp steam grid.....	24
Steam line installation.....	25
Installation – step 5 Power supply installation.....	28
Installation – step 6 Control installation.....	30
Verification before start-up.....	32
Configuration & Operation.....	33
Warranty.....	47

Other Manuals and information that can help you:

- Modbus tables for IER
- BACnet PICS for IER
- IER service manual

Please visit our website: steamOvap.com for the latest revision of all manuals & instructions

You can also visit our Youtube® channel: [youtube/steamovap](https://www.youtube.com/channel/UC...) and watch our 2 minutes IER service/cleaning video.

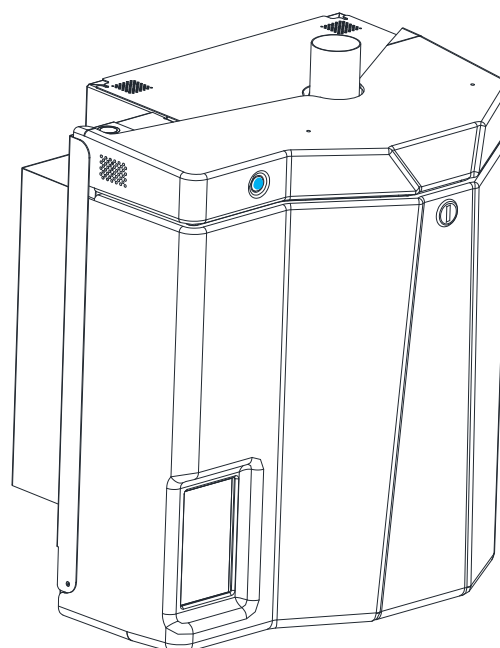

Figure 1, IER one module

Information contained in this manual is subject to change without notice.
To obtain the latest technical information visit our website at steamOvap.com

EC Declaration of conformity

Manufacturer: steamOvap technologies inc.

Address: 1490 Mazurette, Montreal, Qc, H4N 1H2, Canada

Product description: Electric steam humidifier

list of Models: IER02, IER04, IER05, IER09, IER12, IER17, IER22, IER31, IER44, IER62 followed by 3 digits denoting supply voltage and 1 digit denoting number of phase

The products described above are in conformance with the provisions of the following European directives:

2014/35/EU, Low Voltage Directive (LVD)

2014/30/EU, Electromagnetic Compatibility Directive (EMC)

Conformity to above European directives is assured through the application of the following standards:

Reference standard	Edition
EN 60204-1	2006
EN 61000-6-2	2016
EN 61000-6-3	2011
EN 62233	2008

Product modifications after delivery may result in loss of conformity, Safety documentation accompanying the product shall be considered in detail

Done in Montreal on 11/06/2017

SteamOvap technologies inc.

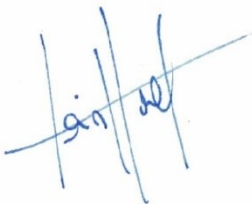

Bernard Saint-Yves
General manager

Safety warnings

General

**Risk of electric shock.**

Disconnect power supply before installation or service.

For safety and warranty reasons, Installation and service of this humidifier should be carried out by trained and qualified personnel.

Any work related to installation and service of this humidifier must comply with local code and regulation regarding safety and prevention of accidents.

Electrical Warning

**Risk of electric shock.**

Disconnect power supply before installation or service.

Power supply connection must be done by a trained and qualified electrician.

Any work related to power supply installation or service of this humidifier must comply with local code and regulation regarding safety and prevention of accidents.

Water safety warning

Any work related to water supply, drain connection as well as steam lines and condensate returns lines installation or service of such for this humidifier must comply with local code and regulation regarding safety and prevention of accidents.

Water supply connection must be done by a trained and qualified plumber.



Risk of malfunction. Steam lines should not have any restriction or blockage that may cause a burst of pressure in the steam line.

Others



Risk of flooding. In order to avoid any risk of flooding **steamOvap** recommends a Hi limit humidity switch installed in the air duct downstream of the steam distribution ramp.

Risk of freezing. Plan an anti-freeze system in case of installation in a location that would be exposed to outside conditions and susceptible of freezing.

Risk of malfunction. Do not block steam outlet(s).

Before to proceed to Installation

Please read this Installation and Operation manual before to proceed to the Installation

Receiving & Unpacking

1. Upon receipt verify that packaging is complete and not damaged.
In case of damage, and/or missing boxes advise immediately the carrier by writing a note on the waybill.
2. Verify that model of the humidifier matches the purchase order and that all accessories are included.
3. Any missing item should be reported as soon as possible to **steamOvap** or its representative and within 5 business days after receipt.
steamOvap will not assume any responsibility for missing item after this delay.
4. Proceed carefully to unpacking, and check that the humidifier and its accessories are not damaged. in case of damage please proceed as for point 3

Included in standard delivery of IER electric steam humidifier

1. IER electric steam humidifier
2. Water supply hose
3. Collar(s) to secure steam hose on steam outlet of IER
4. 80mm long drain connection sleeve DN32 Diameter.
5. This IOM

Depending on other accessories ordered

6. Steam ramp(s)
7. Steam hose
8. Condensate hose
9. RH% sensors for duct or room, or Humidistat
10. HI Limit RH% switch, model DHL
11. Air flow switch, model DAP

IER name plate

steamOvap technologies inc.			
Electric resistive steam humidifier			
MODEL	IER05-230/1		
S/N	YY-DDDXXX		
POWER	5.0kW	VOLTAGE	230Vac
CURRENT	21.7A	NB OF PHASE	1ph
		FREQUENCY	50/60Hz
		www.steamOvap.com	

Figure 2, IER name plate

IER Overview

Model designation and options codification

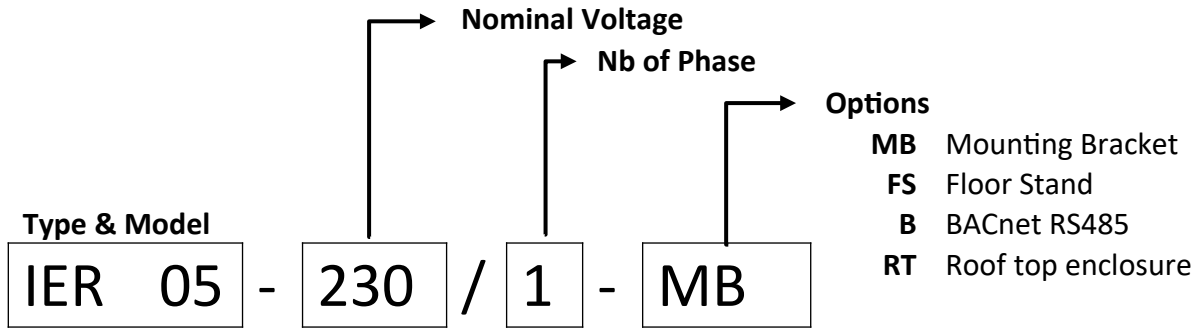

IER electrical rating

Model	Steam Capacity	Power	Current	
			230V/1p	400V/3p
IER02	2.8kg/h	2.1kW	9.2A	-
IER04	4.5kg/h	3.3kW	14.3A	4.8A
IER05	6.8kg/h	5.0kW	21.7A	7.2A
IER09	11.4kg/h	8.3kW	36.1A	12.0A
IER12	15.9kg/h	11.7kW	50.8A	16.8A
IER17	22.7kg/h	16.7kW	-	24.1A
IER22	29.5kg/h	21.7kW	-	31.3A
IER31	42.3kg/h	31.0kW	-	44.7A
IER44	59.1kg/h]	43.3kW	-	62.5A
IER62	84.1kg/h	61.7kW	-	89.1A

IER Dimensions & weight

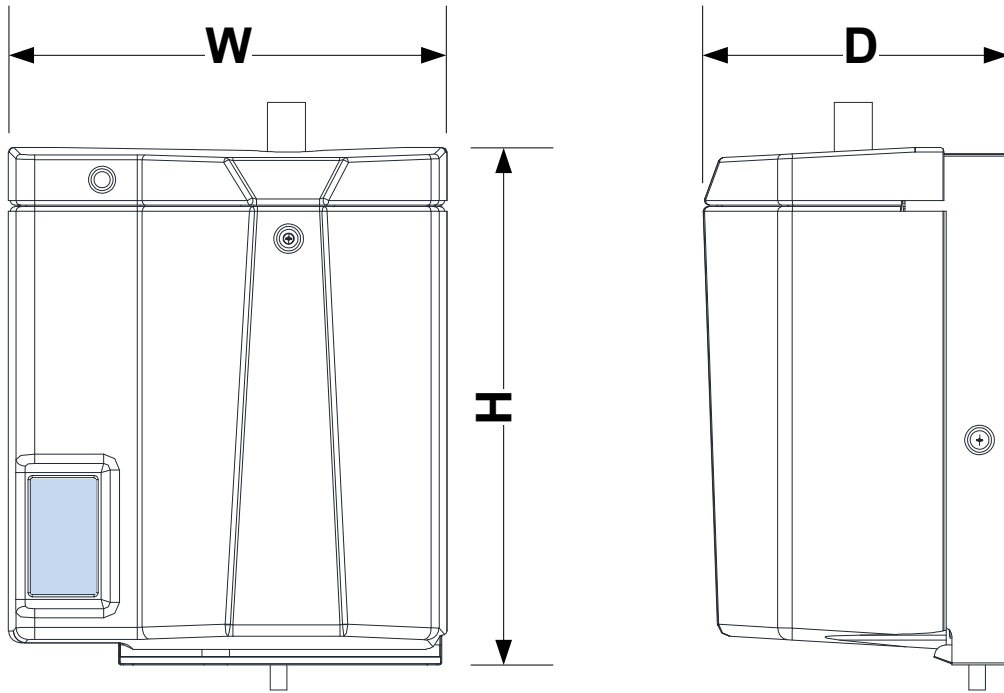

Figure 3, IER Dimensions, single module

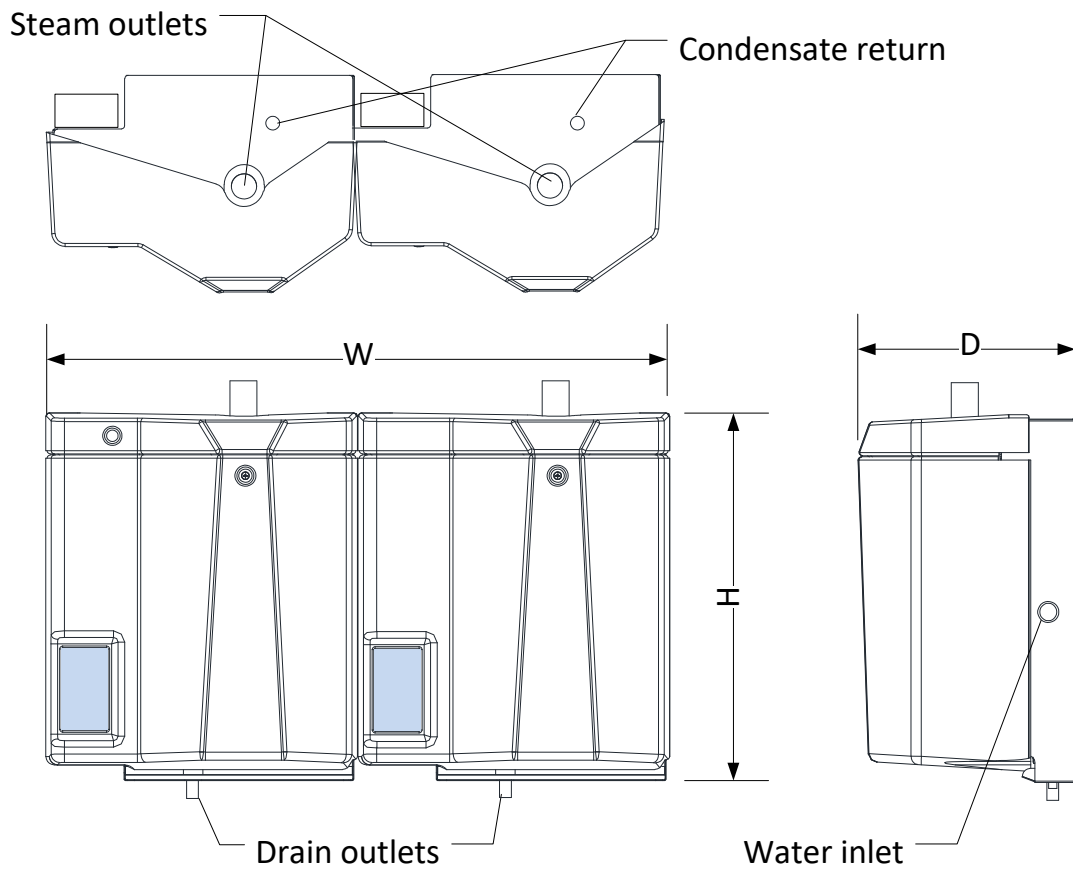

Figure 4, IER Dimensions, two modules, model IER44 & 62

OVERVIEW

Model	Steam Capacity	Nb Cyl + size	Nb Steam Outlet + Ø	Dimensions			Net weight
				W	H	D	
IER02	2.8kg/h	1x small	DN40	510mm	585mm	330mm	21kg
IER04	4.5kg/h	1x small	DN40	510mm	585mm	330mm	21kg
IER05	6.8kg/h	1x small	DN40	510mm	585mm	330mm	21kg
IER09	11.4kg/h	1x small	DN40	510mm	585mm	330mm	21kg
IER12	15.9kg/h	1x medium	DN50	585mm	686mm	432mm	31kg
IER17	22.7kg/h	1x medium	DN50	585mm	686mm	432mm	31kg
IER22	29.5kg/h	1x medium	DN50	585mm	686mm	432mm	31kg
IER31	42.3kg/h	1x medium	DN65	585mm	686mm	432mm	31kg
IER44	59.1kg/h	2x medium	2x DN50	1067mm	686mm	432mm	62kg
IER62	84.1kg/h	2x medium	2x DN65	1067mm	686mm	432mm	62kg

Installation overview

General

1. Installation of this humidifier should be carried out by trained and qualified personnel.
2. Any work related to installation of this humidifier must comply with local code and regulation regarding safety and prevention of accidents.



WARNING. Risk of electric shock.

Power supply must be disconnected during installation.

Main power should be connected only after all installation steps have been completed and properly verified.

Typical installation with steam ramp

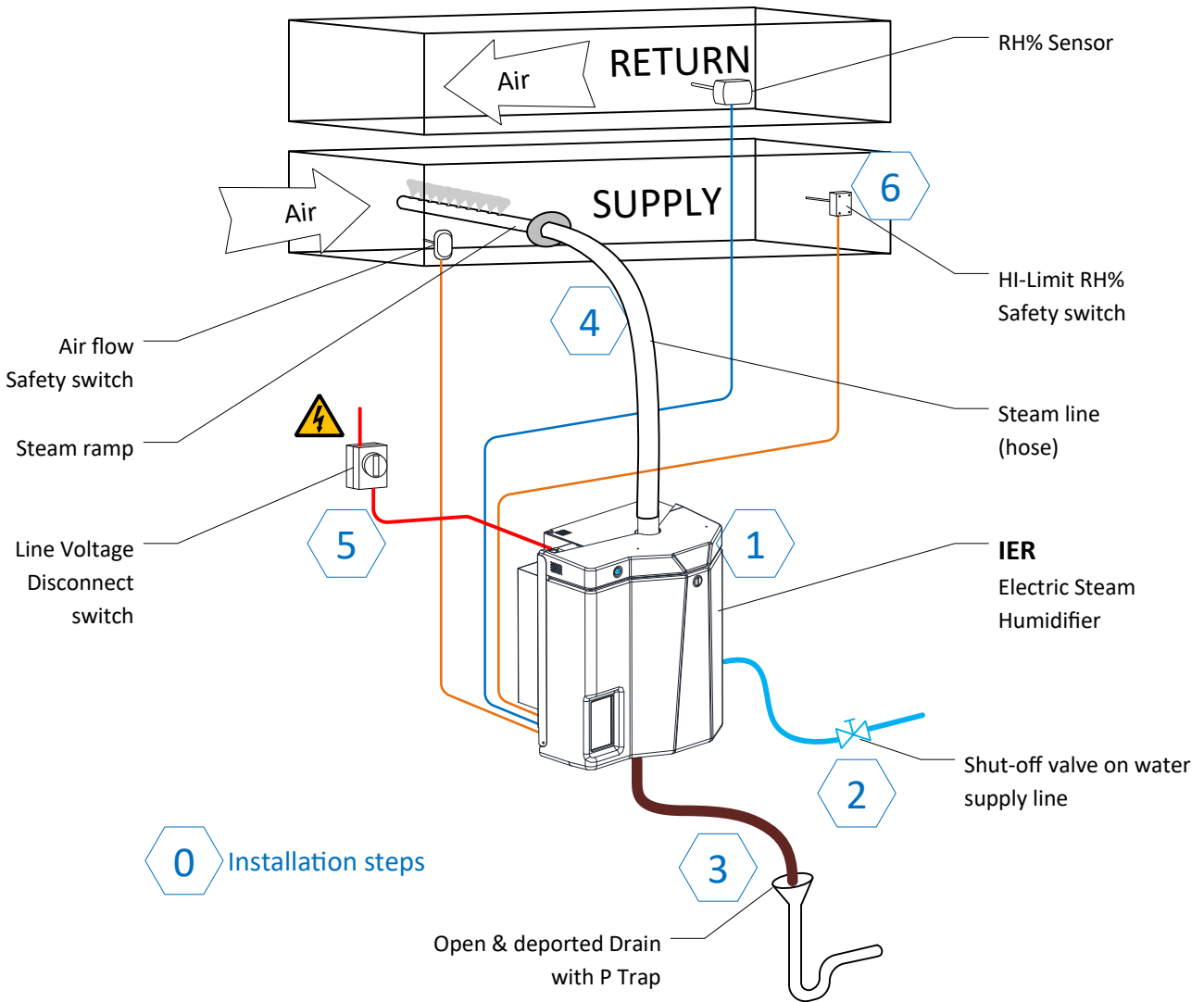

Figure 5, installation overview with steam distribution in duct

INSTALLATION

Installation steps :

1. Positioning & mounting of IER electric steam humidifier
2. Water supply installation
3. Drain installation
4. Steam line installation for duct humidification or Direct humidification in room
5. Power supply installation
6. Safety & RH% control installation

Typical installation with SB- space blower

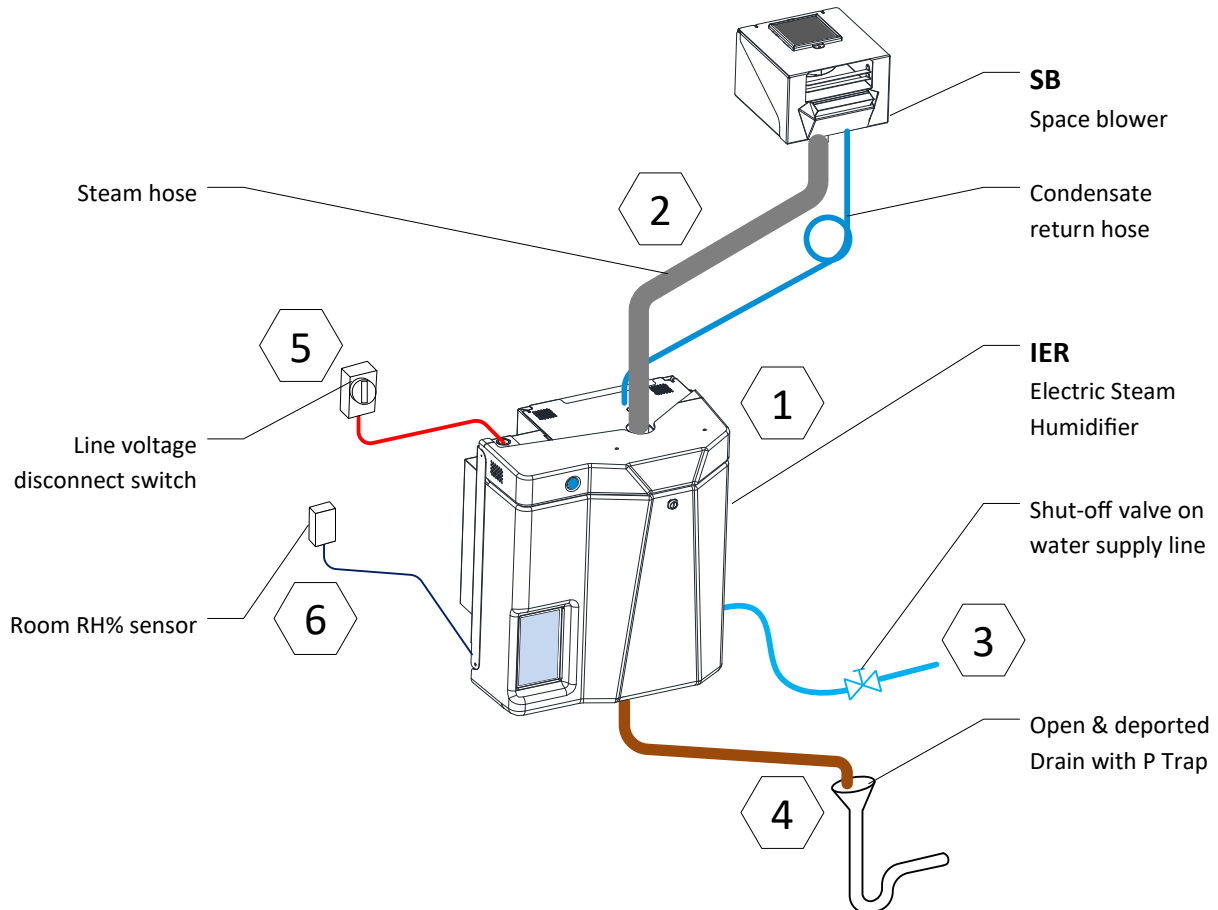

Figure 6, IER with remote Space blower typical installation

Typical installation steps :

1. Positioning & mounting of IER electric steam humidifier
Space blower installation (only if remote)
2. Steam & condensate return hose or piping
3. Water supply installation
4. Drain installation
5. Power supply installation
6. RH% control installation

Installation – step 1

IER Positioning & Mounting

General guidelines for positioning

IER electric steam humidifier should be positioned so that:

- Length of the steam line (or hose) is as short as possible,
- In case steam hose is used, the bend radius of 300mm is ensured
- Humidifier is easily accessible for service



CAUTION. Risk of malfunction due to vibration. Do Not mount IER electric steam humidifier directly on ventilation duct.

CAUTION. Risk of flooding. Ensure that the local where IER electric steam humidifier will be installed is equipped **with floor drain**.

In case of no floor drain is available; installation of a water leak detector is required in order to prevent any flooding in case of abnormal operation or service.

IER steam humidifier should be installed in a well-ventilated and dry environment.

If local is subject to below freezing point temperature, activation of ant freezing function of the IER steam humidifier is required.

For outdoor installation please contact your **steamOvap** representative to order and install special **RT** outdoor enclosure for **IER**.

IER maximum ambient conditions:

Temperature: +5 to +45°C

Relative Humidity: 90%RH max (non condensing)

Ingress Protection for IER standard enclosure: IP30

Clearances

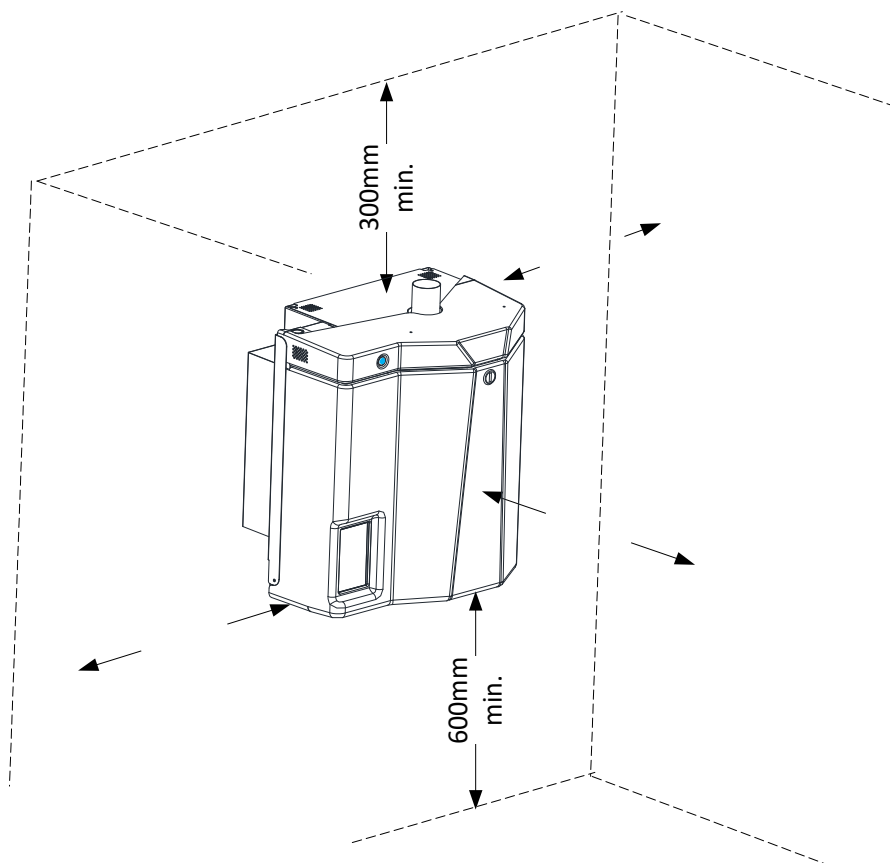

Figure 7, minimum clearances

INSTALLATION

Clearance guidelines

There is no minimum clearance on both side of the **IER** humidifier, however it is a good practice to allow a clearance of 100 to 200mm for ease of installation and service

Allow a minimum clearance of 600mm with floor to allow for proper drain slope and drain pipe column.

Front clearance of 760mm is required for access to the **IER** humidifier.

Top clearance is required of 300mm for access and ease of steam line connection.

Clearances for IER with space blower

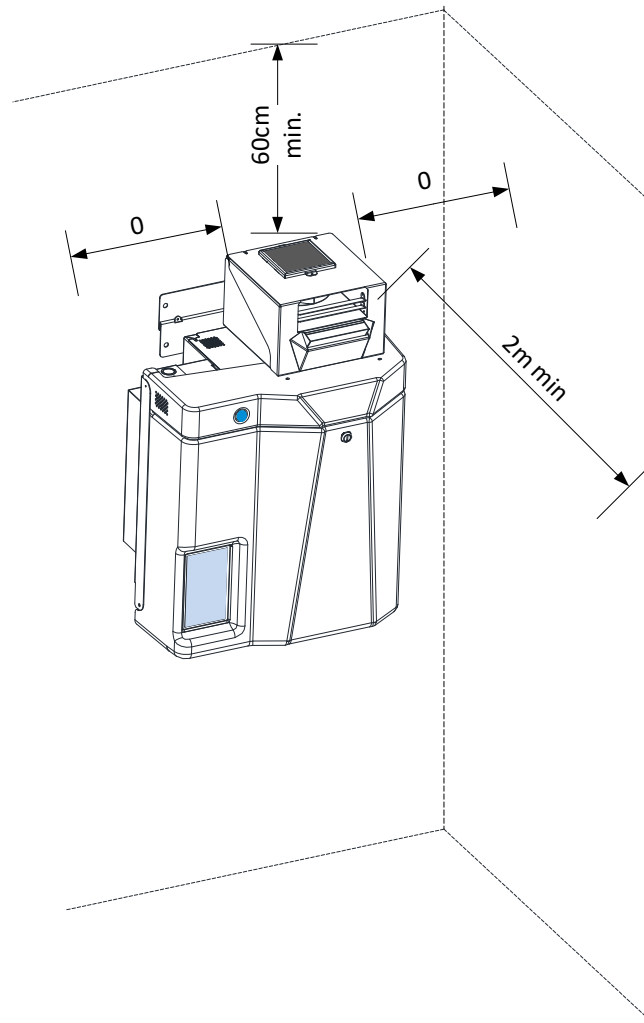

Figure 8, minimum clearances for SB

Clearance guidelines

There is no minimum clearance on both side of the SB- space blower, but it is a good practice to have a clearance of 100 to 200mm for ease of installation and service.

Front clearance of 2000mm is required for steam absorption.

A 600mm top clearance above SB – space blower is required for access and for steam absorption to avoid any condensing on the ceiling.

Mounting holes positions & weights

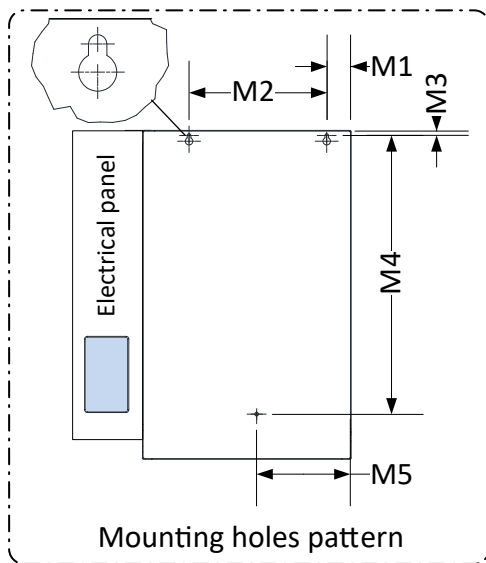

Figure 9, mounting holes single module (IER 04 to 31)

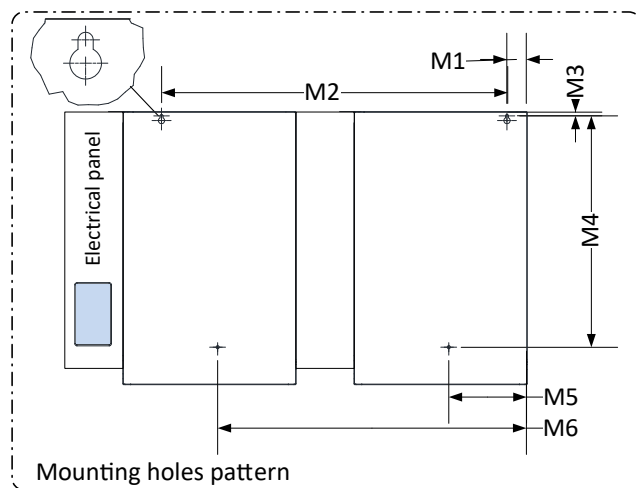

Figure 10, mounting holes double module (IER 44 & 62)

Model	Mounting holes positions [mm]					
	M1	M2	M3	M4	M5	M6
IER02 to 09	51	203	13	489	152	-
IER12 to 31	51	286	13	597	197	-
IER44 & 62	51	871	13	597	197	782

Weight

Model	Nb Cyl + size	Net Weight	Oper. Weight
IER02	1x small	21kg	34kg
IER04	1x small		
IER05	1x small		
IER09	1x small		
IER12	1x medium	31kg	54kg
IER17	1x medium		
IER22	1x medium		
IER31	1x medium		
IER44	2x medium	62kg	108kg
IER62	2x medium		

General guidelines for Mounting



CAUTION. Risk of malfunction. IER electric steam humidifier must be levelled in X & Z axis.

Installation on wall (without mounting bracket)

1. Verify that wall structure and strength is appropriate to support the operating weight of the IER electric steam humidifier.
In case, the wall is not solid enough to support operating weight of **IER** electric steam humidifier, install humidifier on the floor stand (**FS** option is available to your steamOvap representative).
2. Mark the wall or support according to the above holes location, and drill 4 holes to the wall or support as per the size of anchors and/or screws.
3. Use anchors of sufficient size (at least 6mm). Insert those anchors and the 2 top screws, ensure that the screw heads extends 6mm from the wall, so that the **IER** electric steam humidifier will be able to be hung on those 2 screws.
4. With front cover removed, hung the **IER** electric steam humidifier onto the 2 top screws. Insert the bottom screw through the back plate of the humidifier and into the anchors in the wall.
Ensure that the humidifier is properly levelled.
Tighten the 3 screws. Re verify the level in the 2 direction X and Z axis.
5. Re-install the front cover to the humidifier.
6. Optional Mounting bracket (option **MB**) is available to your steamOvap representative in order to ease up wall mounting process.

Installation on wall (with mounting bracket – option MB)

1. Optional Mounting bracket (option **MB**) is available to your steamOvap representative in order to ease up wall mounting process.
2. Verify that wall structure and strength is appropriate to support the operating weight of the IER electric steam humidifier.
In case, the wall is not solid enough to support operating weight of **IER** electric steam humidifier, install it on a floor stand (**FS** option is available to your steamOvap representative).
3. Mark the wall or support according to the mounting bracket holes location, Drill holes to the wall or support to attach the bracket to the wall as per the size of anchors and/or screws.
Distance between the 2 holes in mounting bracket is 381mm

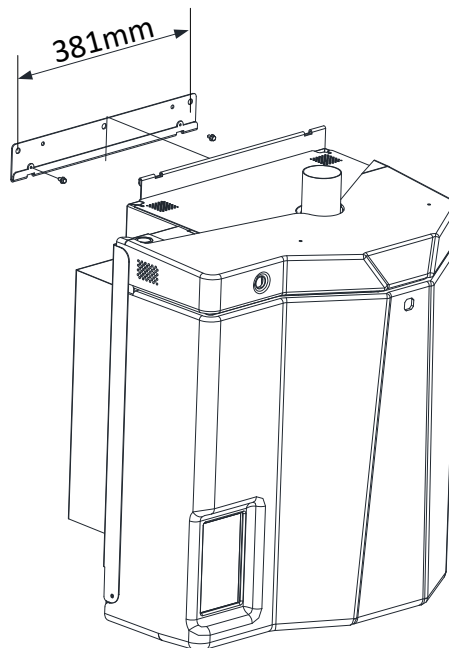

Figure 11, Installation with Mounting bracket

4. Use anchors of sufficient size (at least 6mm). Install the mounting bracket to the wall or support.
Ensure that the mounting bracket is properly levelled.
5. With front cover removed, hung the IER electric steam humidifier onto the mounting bracket.
6. Install the 2 supplied screws to avoid the IER humidifier to move up from the mounting bracket.
7. Re-install the front cover to the humidifier.

Installation on Floor Stand (option FS)

1. Ensure that the floor structure and strength is appropriate to support the operating weight of the **IER** electric steam humidifier.
2. Attach the floor stand to the floor or structure to avoid any movement of the **IER** electric steam humidifier.
You can use bolt or screws to attach this one to surrounding structure or to the floor.
3. Install Humidifier (with front cover removed) on the floor stand and secure it with supplied bolts.
4. Re-install the front cover to the humidifier.

Installation – step 2

Water supply installation

Water supply specification & quality:

Water supply pressure: 1 to 5bar

Water supply temperature: 3 to 40°C

IER electric steam humidifier can accept a wide range of water quality.

Untreated water will lead to scale deposits that will need to be regularly removed from steam chamber.

Use of additives such as scale inhibitor or corrosion inhibitors, disinfectants or other can impair the normal operation of the humidifier and are not allowed.

Water supply conductivity: 1 to 1500µS/cm

Water supply hardness: 268mg CaCO₃/l [0 to 15°gH]

Water supply PH: 6.5 to 7.5

Water supply chloride content: 0 to 50ppm

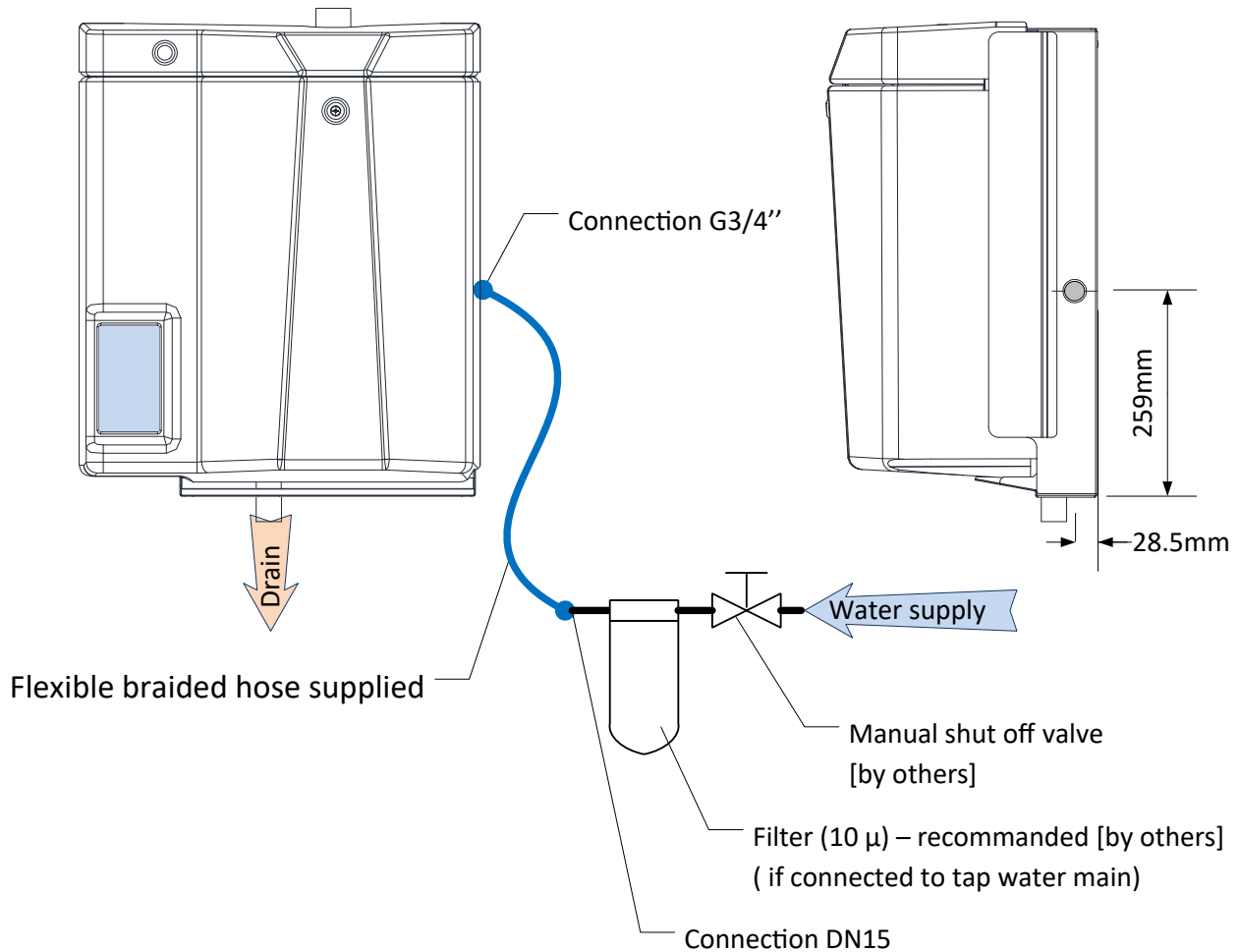

Figure 12, water supply connection

Water supply connection:

1. Install a manual shut off valve (supplied by others) on the water main line.
2. If **IER** humidifier is supplied with tap water it is recommended to install a 10 μ sediment filter (supplied by others) on the line.

Alternatively **steamOvap** can provide a 2 stages pre-filter 5 + 1 μ PP filter as extra protection and filtration (model WF-51).

3. A flexible braided hose is supplied for an easy and secure connection to the humidifier water supply inlet.

This flexible braided hose will ease of the installation and act as shock absorber and protection for the internal water fill valve.

Installation – step 3

Drain installation

Water drained specification:

Drained water maximum temperature: 60°C (when supplied with cold water supply)

Drained water flow rate: 25 l/min

Drain outlet dimension: IER04 to IER31: (1x) [32mm]

IER44 & IER62: (2x) [32mm]

Drain volume for full cylinder drain: IER04 to 09: 21L

IER12, IER17, IER22, IER31: 46L

IER44 & 62: 86.5L

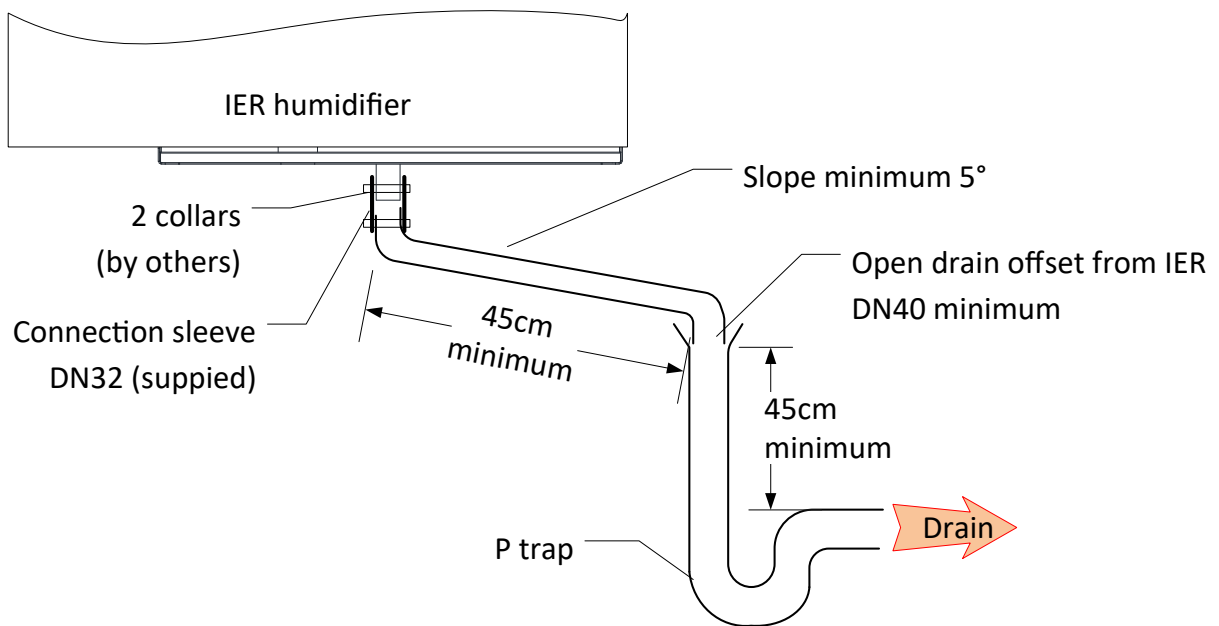

Figure 13, water drain connection (single module)

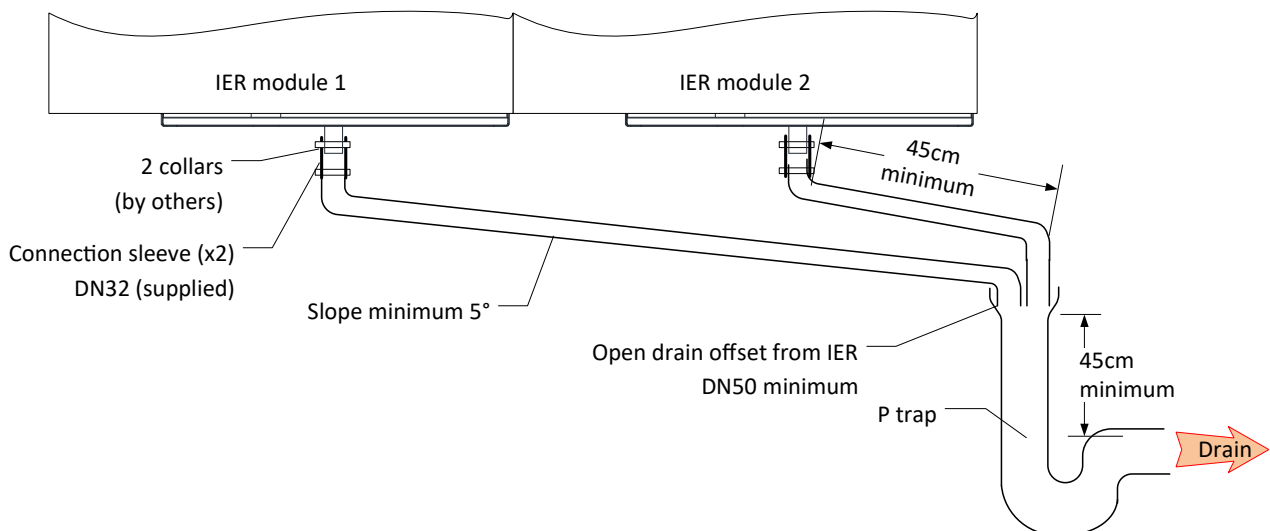

Figure 14, water drain connection, 2 modules, model IER44 & 62



Risk of overflow.

- ✓ A minimum slope angle of **5 degree of the drain hose or pipe and a minimum length of 60cm** must be provided between **IER's** module drain outlet and building's open drain inlet.
- ✓ Do not reduce diameter of the drain line. Drain line between **IER's** module drain outlet and building's open drain inlet must be **DN32 diameter minimum**
- ✓ **45cm minimum vertical run** before P trap or obstruction must be provided.
- ✓ Do not install P-trap directly (or any other obstruction) at the **IER's** drain outlet.

Installation steps :

Important note: There is one drain outlet per IER module.

So there are 2 drain outlets for models IER44 and IER62.

1. Ensure that an Open drain with a P-trap is installed offset from the IER humidifier.

Main building drain diameter should be

- DN40 for single module **IER**
- DN50 for two modules **IER** (model IER44 or IER62)

in case such drain diameter is not available (i.e. in old building), increase the diameter or height of vertical run before to enter the main building drain.

Refer to information of full cylinder volume above for volume calculation.

2. Drain line can be made either with flexible hose or hard pipe.

Supplied connection sleeve DN32 allow for ease of connection to **IER's** module drain outlet to the drain pipe, and secure it with the supplied 2 collars.

- ✓ Drain line must be sloped - 5° minimum slope from IER module to building's open drain inlet.
- ✓ Do not reduce DN32 diameter at any point of the drain line
- ✓ Avoid short 90° elbow
- ✓ a minimum 45cm vertical run pipe must be provided upstream any P-trap or any other obstruction.

Installation – step 4

Steam distribution installation

SR models for horizontal in duct humidification

SRS(X)(E) - steam ramp with slope



Figure 15, SRS(X)(E)

Main feature:

Easiest to install.

Not recommended when large quantity of condensate is produced (in case of long steam line run or large duct with low air temperature).

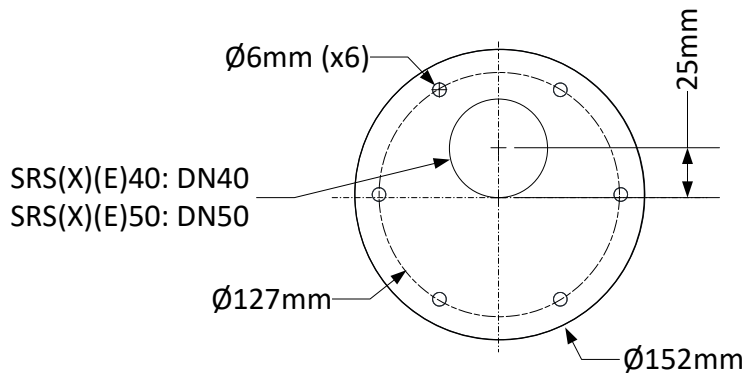

Figure 16, SRS (X) (E) cover plate dimension

SRC(X)(E) - steam ramp with condensate return

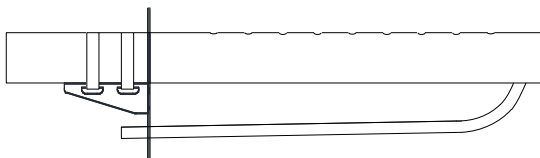

Figure 17, SRC

Main feature:

Avoid any possible trouble due to condensate flow against the steam flow inside steam pipe or hose.

A condensate line must be installed and connected to drain or returned to humidifier

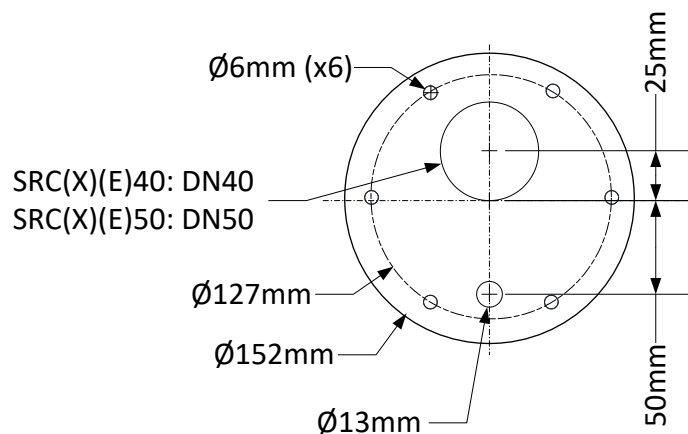

Figure 18 – SRC (X) (E) cover plate dimension

Option E – High efficiency

Option E denotes steam ramp with thermal insulation. It is available on any steam ramp model, SR or SO.

Insulation material is rated ASTM E84 (equivalent to UL723), safe for direct contact with flame and 260°C continuous operating temperature.

SRS or SRC
One row of nozzle

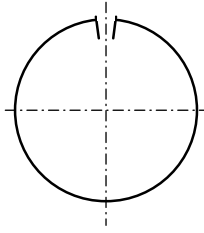

Figure 19, SRS or SRC

SRSX or SRCX
Two rows of nozzles

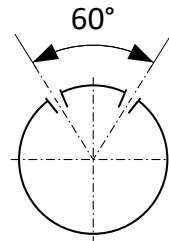

Figure 20, SRSX or SRCX

SR models for Vertical duct - Option -V

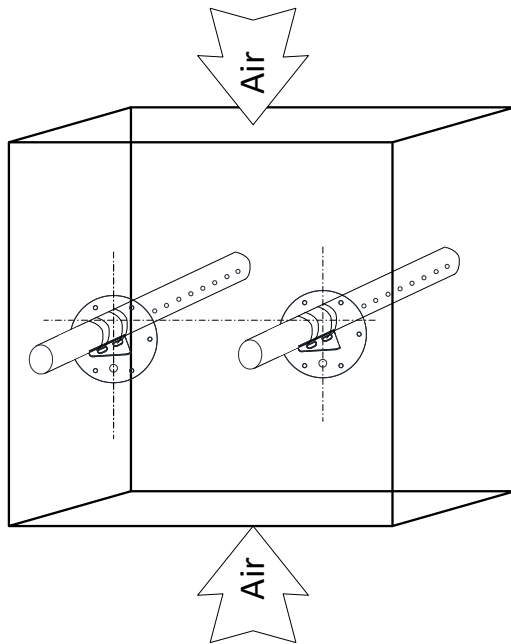

Figure 21, SRS -V on vertical air flow duct

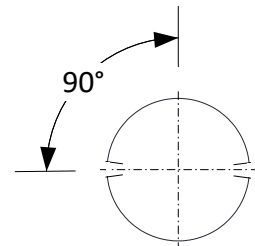

Figure 22, SRS or C-V section

SR models for round duct - Option -R

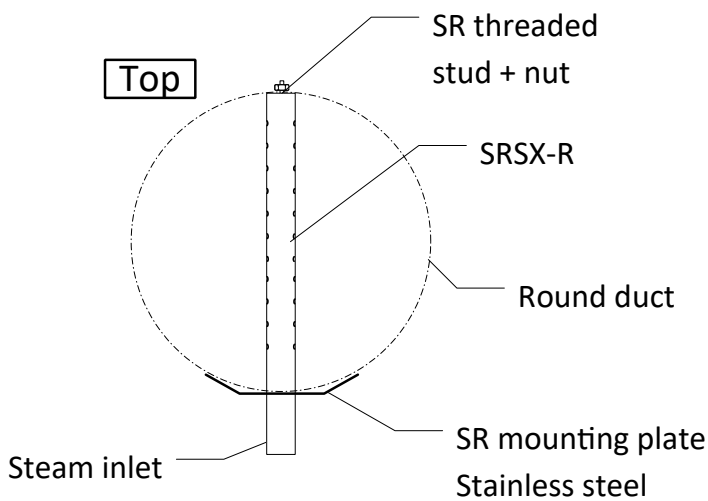

Figure 23, SRS -R on round duct

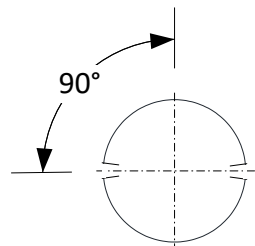

Figure 24, SRSX-R section

Minimum distances for SRS & SRSX

Horizontal duct

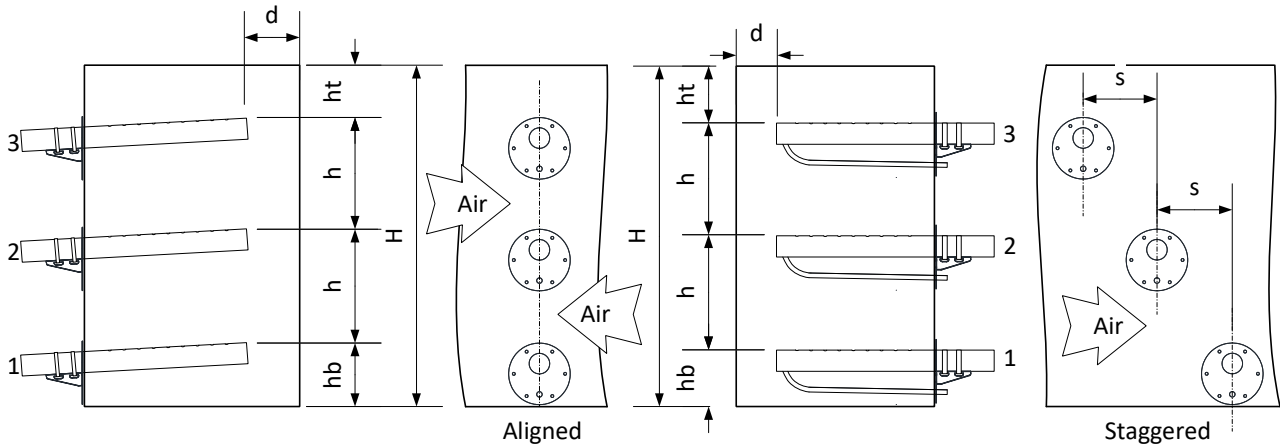

Figure 25, minimum distance SR in horizontal duct

Here are some guidelines to avoid condensing on the duct surface or on SR steam ramps

- ht(min)
For **SRS** : Minimum height distance between end of top ramp (#3) and top of the duct.
ht (min) =115mm
For **SRC**: Minimum height distance between end of top ramp (#3) and top of the duct.
ht (min) = 115mm
- d(min) Minimum depth distance between top ramp and side wall of the duct.
d(min) = ht(min) = 115min
- hb(min) Minimum height with bottom of duct
There is no minimum height distance required for the bottom ramp (#1) and the bottom of the duct. However we recommend a minimum: hb(min)=100mm
- h(min) Height in between ramps (h) should be equal / even.
h=H-(ht+hb)/(nb of ramps -1),

If ramps are aligned

h(min) = 200mm

Air flow can be in any direction

If ramps are staggered

h(min) = 115mm

Important: the air flow direction should be as indicated on above drawing.

s(min) minimum distance between ramps

s(min) = 100mm

Vertical duct

Same logic of spacing should be applied when **SR** steam ramps are installed in a vertical duct

"d" in vertical duct is equivalent to "ht" or "hb" in horizontal duct

"s" in vertical duct is equivalent to "h" in horizontal duct configuration

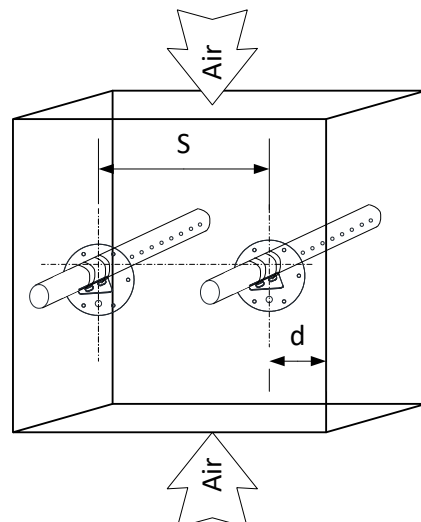

Figure 26, minimum distance in vertical duct

INSTALLATION

SOS or SOE – steamOsorb, multi-ramp steam grid

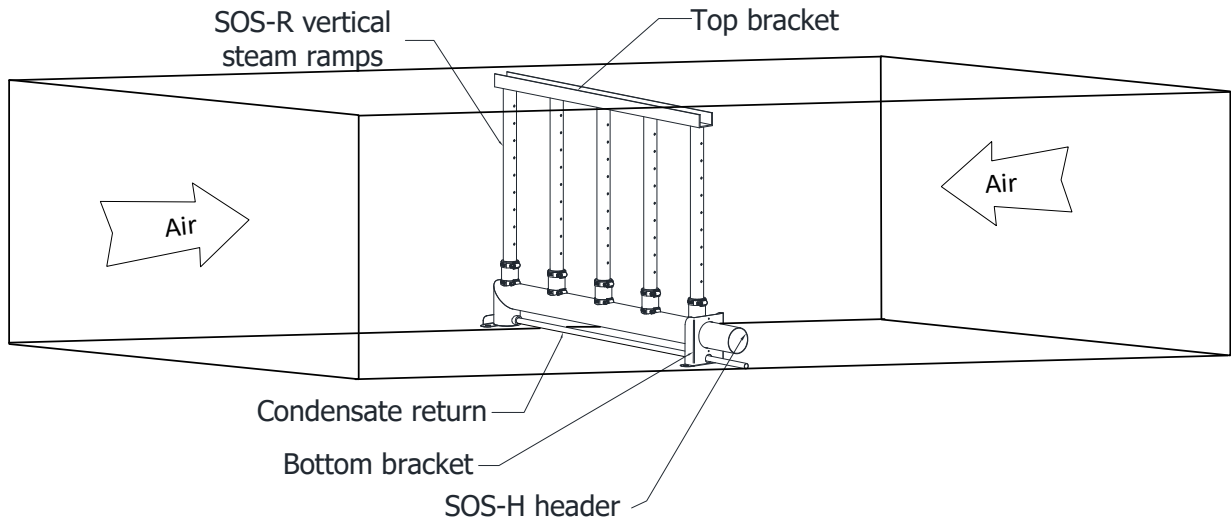

Figure 27, steamOsorb (SOS or SOE) multiramp installation

Main features:

Made to measure to fit inside ventilation duct; header diameter will adapt to maximum capacity; quantity of vertical ramps and quantity of nozzle will depend on max capacity and non wetting distance.

SO with option FF or FI

Frame with flanges or Frame for insertion

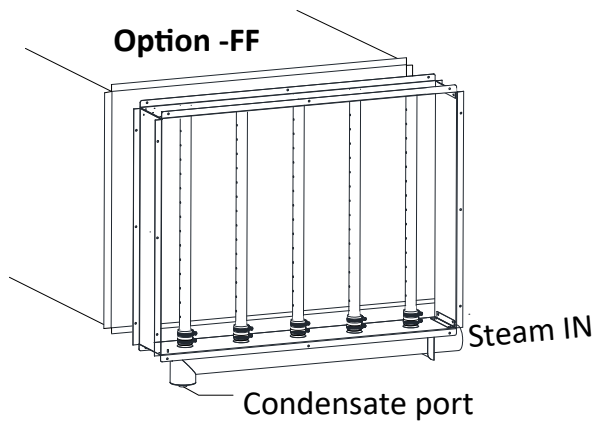

Figure 28, Option -FF Frame with flanges

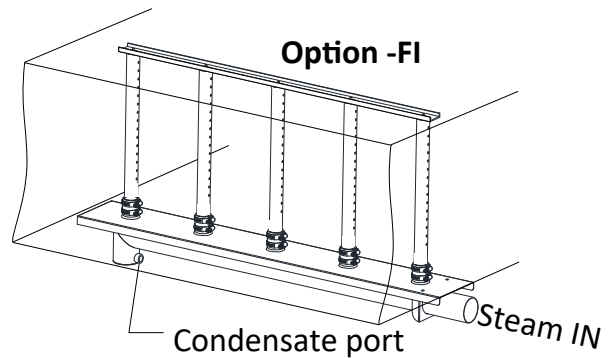

Figure 29, Option -FI Frame for Insertion

SO for Vertical duct

Option -V

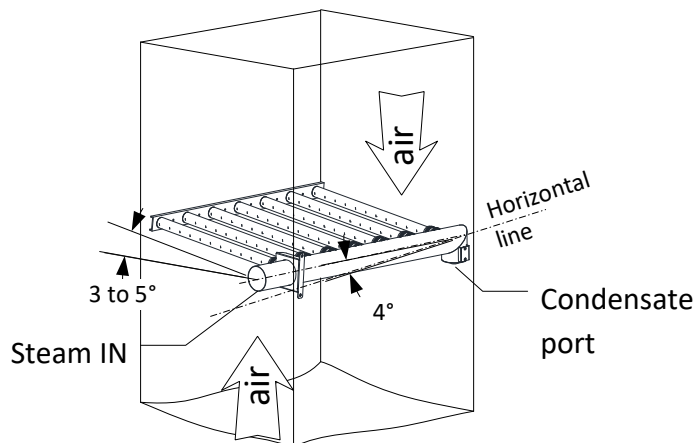

Figure 30, steamOsorb (SOS or SOE) for vertical air flow duct

INSTALLATION

Steam line installation

steamOvap recommends the use of rigid pipe (stainless steel or copper) for steam line longer than 3m.

There is no maximum length for steam line, however plan for the following steam losses depending on material used and length :

Losses [kg/h/m]	Hose		Rigid pipe (stainless steel or copper)					
	Diam	DN40	DN50	DN40	[DN50]	[DN80]	[DN100]	[DN125]
Non insulated		[0.23]	[0.33]	[0.18]	[0.22]	[0.31]	[0.40]	[0.46]
	With thermal insulation [50mm] thick			[0.045]	[0.045]	[0.06]	[0.06]	[0.075]

When using flexible steam hose, ensure that the hose is maintained and attached in order to avoid any kink or sagging.



Caution: Risk of malfunction. Steam lines should not have any restriction or blockage that may cause a burst of pressure in the steam line.

Do not reduce diameter of the steam line from humidifier steam outlet to steam distribution ramp(s).

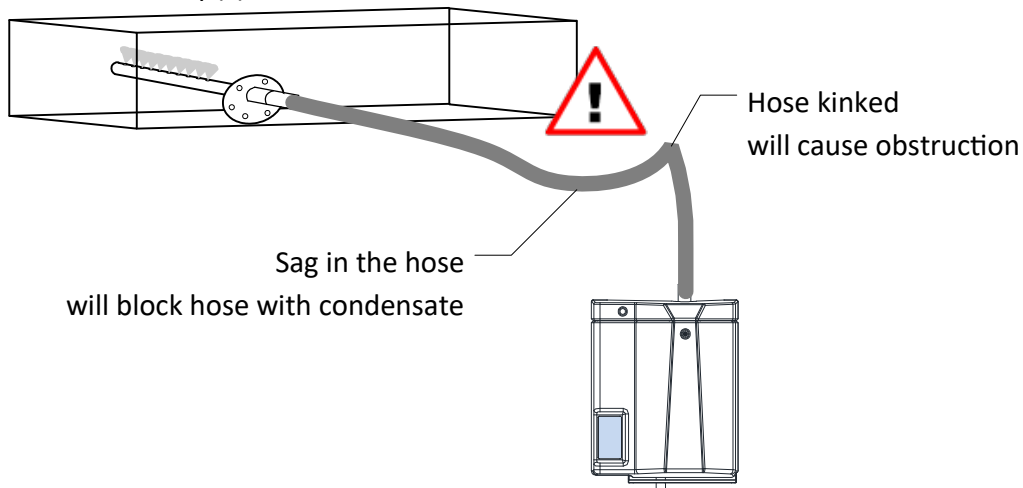

Figure 31, Kink or hose sagging will cause damage & malfunction

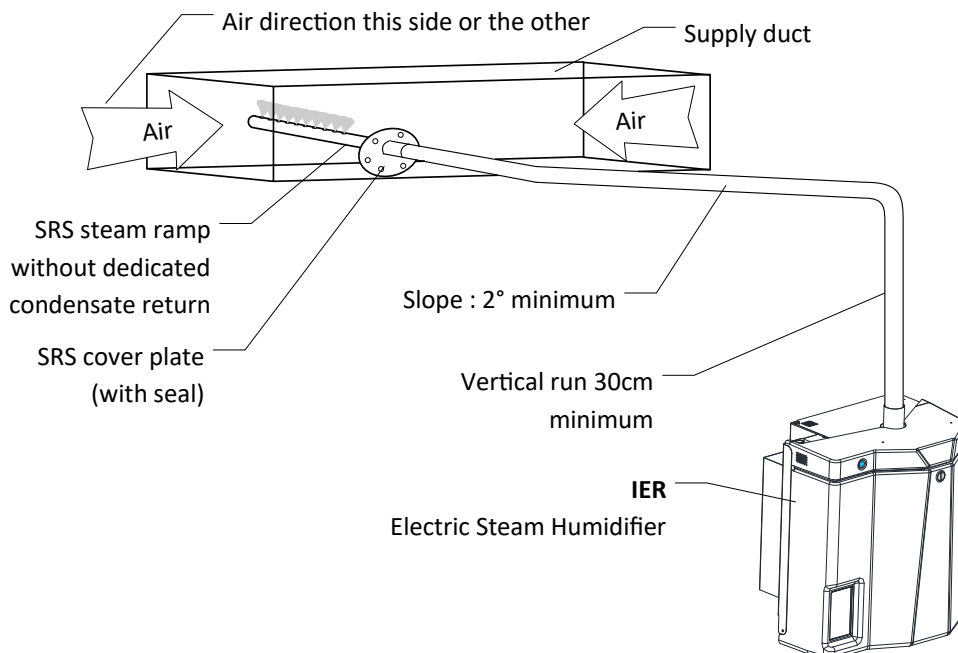

Figure 32, Typical SRS & SRSX installation – no condensate return line

INSTALLATION

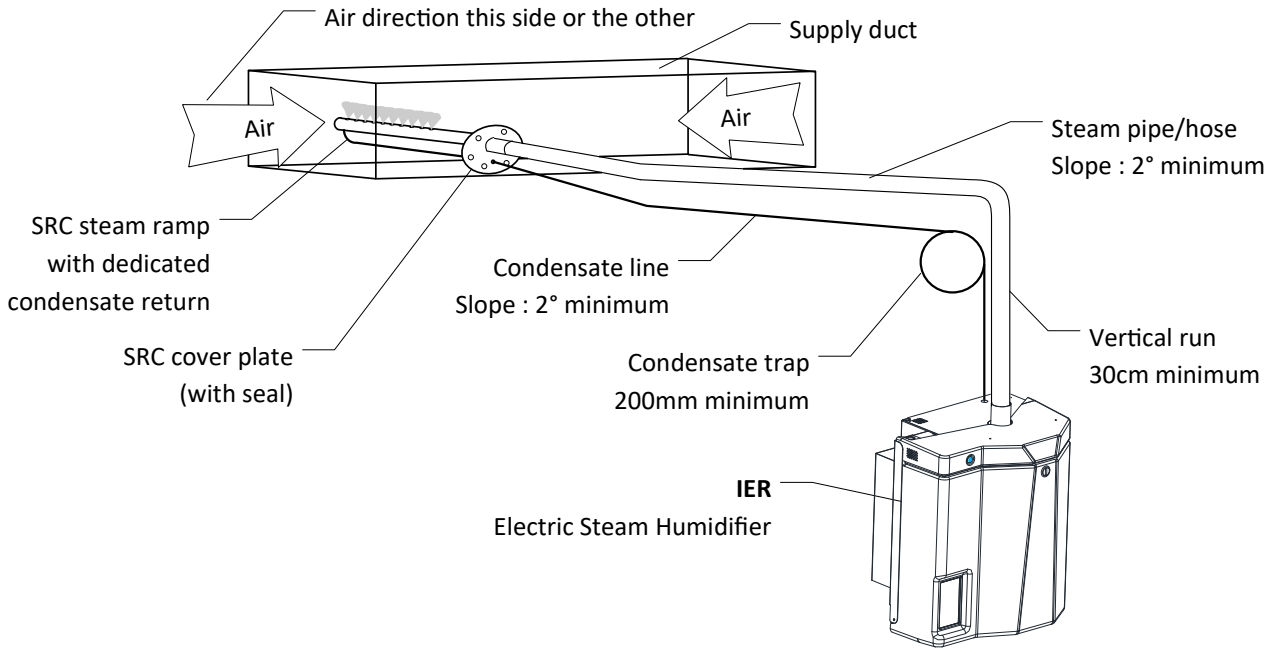

Figure 33, Typical SRC, SRCX or SO installation – with condensate return line to IER

Long steam line installation

Make sure to install condensate trap(s) at each of the steam line low point(s)

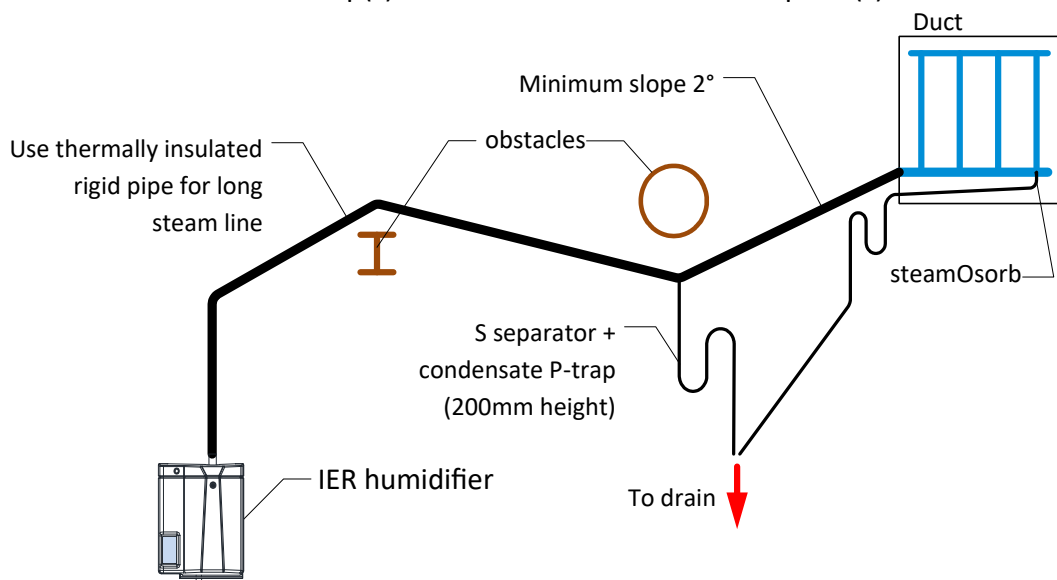

Figure 34, Long steam line run

Installation steps :

1. Positioning & mounting of **SR** steam ramp or **SO** steamOsorb multi-ramp steam grid to the ventilation duct wall by using metal screw
2. Install steam hose or rigid steam pipe between the **IER** steam humidifier and the steam ramp.

Note: when using rigid steam pipe (stainless steel or copper) it is a good practice to install small lengths of steam hose in between steam ramp(s), **IER** humidifier and rigid pipe for ease of installation and service.

Allow for a 2° minimum slope.

3. Secure all steam line connections with hose clamps
4. For **SRC**, **SRCX**, **SOS** or **SOE** install a condensate hose in between steam ramp and **IER** humidifier or direct the condensate return hose to a building drain inlet (if more convenient).

Provide a condensate trap of 200mm minimum

INSTALLATION

Condensate return hose or rigid pipe must be installed so that a slope of 2° minimum is ensured.

- Secure all condensate return line connections with hose clamps

SO or SR lower than IER humidifier steam outlet

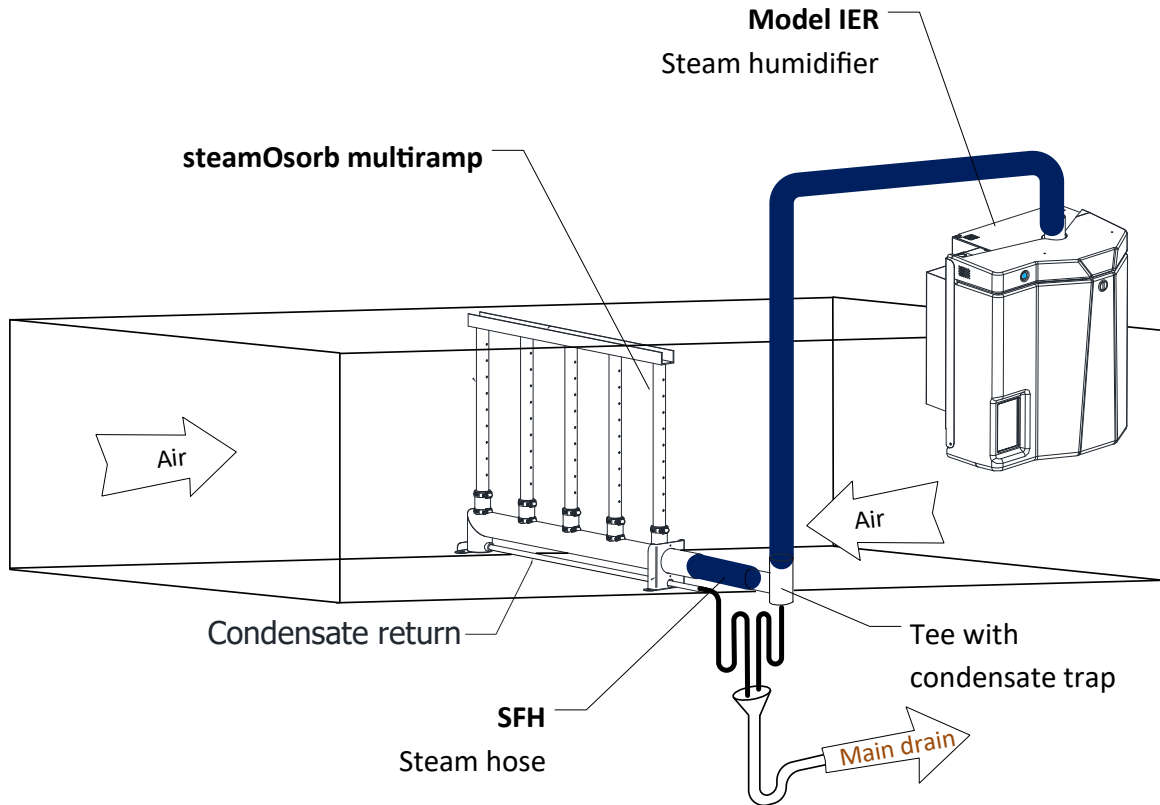

Figure 35, steamOsorb multiramp install lower than IER

When **SR** steam ramp or **SO** steamOsorb multiramp is installed lower than the **IER** humidifier steam outlet, a tee with condensate port must be installed at the lowest point of the steam line. Condensate should be evacuated through a trap. The height of the condensate trap should be duct static pressure in Pa/10 + 50mm

Remote Space Blower

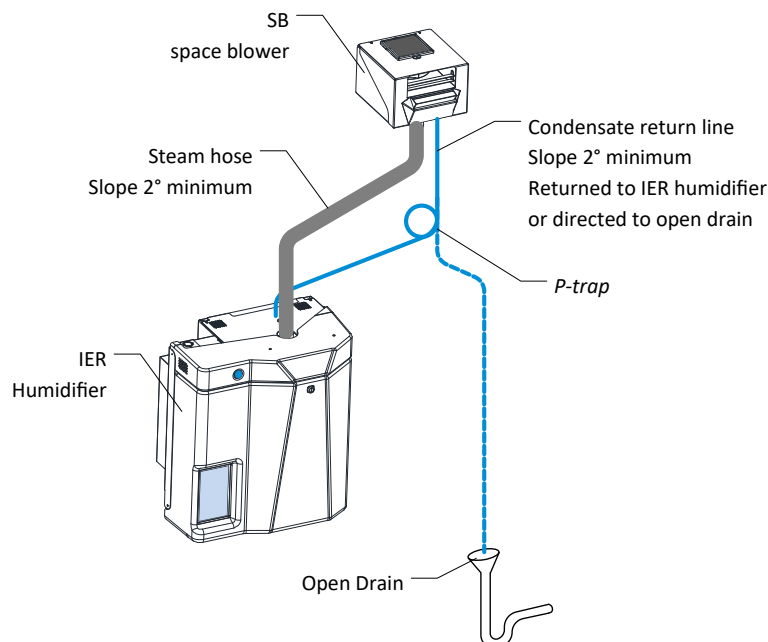

Figure 36, Steam & condensate line for Remote SB

Refer to SB- Space blower IOM for installation guidelines

Installation – step 5

Power supply installation

Electrical Warning



Risk of electric shock.

Disconnect power supply before installation or service.

Power supply connection must be done by a trained and qualified electrician.

Any work related to power supply installation of this humidifier must comply with local code and regulation regarding safety and prevention of accidents.

General guidelines for power supply installation

Power supply wiring conductors must be copper only and rated for 105 °C.

Refer to the above current rated to determine the appropriate wire sizes as well as conduit size and fused disconnect requirements.

The earth must be made by solid metal to metal connections.

Ground wire should be same size as power wiring.

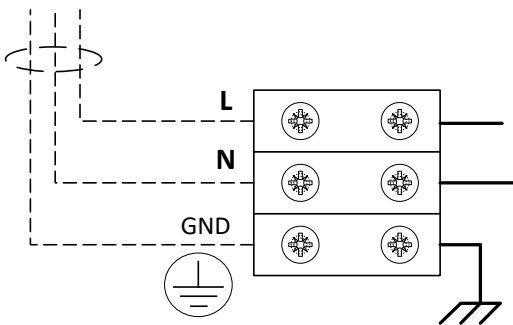

Figure 37, 1 phase power supply connection

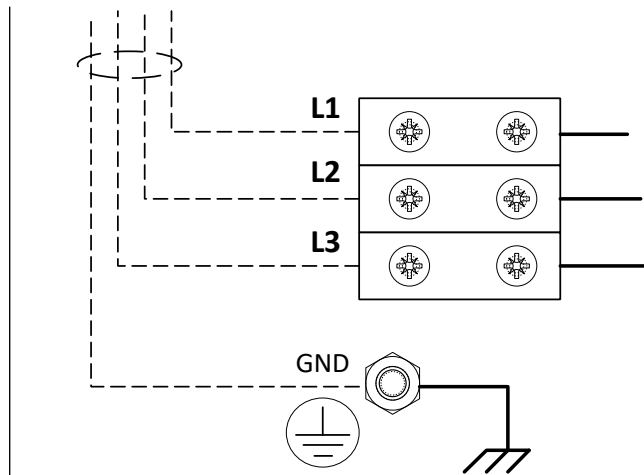

Figure 38, 3 phases power supply connection

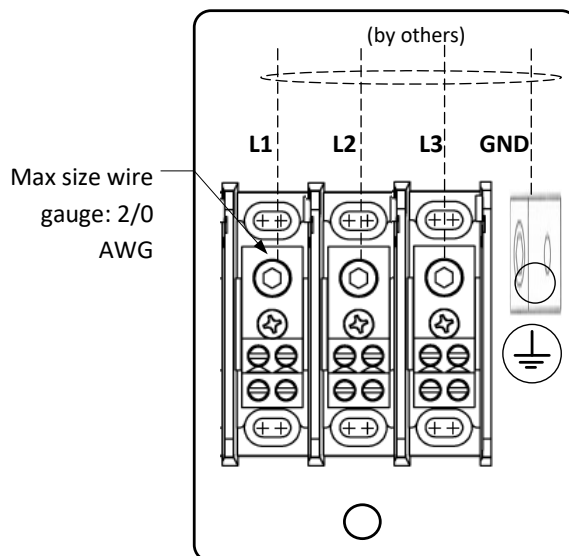

Figure 39, 3 phase power supply connection for IER44 & IER62

IER electrical rating

Model	Steam Capacity	Power	Current	
			230V/1p	400V/3p
IER02	2.8kg/h	2.1kW	9.2A	-
IER04	4.5kg/h	3.3kW	14.3A	4.8A
IER05	6.8kg/h	5.0kW	21.7A	7.2A
IER09	11.4kg/h	8.3kW	36.1A	12.0A
IER12	15.9kg/h	11.7kW	50.8A	16.8A
IER17	22.7kg/h	16.7kW	-	24.1A
IER22	29.5kg/h	21.7kW	-	31.3A
IER31	42.3kg/h	31.0kW	-	44.7A
IER44	59.1kg/]	43.3kW	-	62.5A
IER62	84.1kg/h	61.7kW	-	89.1A

Installation steps :

1. Connect supply lines (L1, L2, L3 and GND or L, N and GND) to the corresponding terminals in the **IER** electrical compartment.
Connect the earth conductor with a lug and secure it to the GND threaded stud..
2. The supply wiring is to be fed into the unit via the clamp strap on the top of the unit.
3. Ensure that an all pole disconnecting device with a minimum contact clearance of 3 mm and a fuse protection (supplied by others) is installed on the power supply line.
4. This disconnecting device should be installed in proximity of the **IER** steam humidifier (within 1 m) and must be easily accessible.

Installation – step 6

Control installation

General guidelines for control installation

It is a good practice to install the following safety controls:

- An air proving switch (model DAP) in the same duct as the humidifier's steam ramp so that it can prevent humidifier from producing steam in case there is no air flow.
- A high limit humidistat (model DHL) shall be installed downstream of the steam ramp so that it can prevent any over humidity (condensing) occurrence. High limit humidistat is usually provided by an on-off switch its set point should be 85%RH minimum. High limit humidistat should be placed at least at a distance equivalent to five times the non wetting distance (NWD). If the NWD is not known, locate it at least 3m downstream of the steam ramp.

For system that needs very accurate RH% control a RH% sensor can replace or supplement the On/Off Hi Limit humidistat in this case the **IER** humidifier will not only modulate the steam production based on the control; signal demand but also on this proportional Hi-Limit signal.

- An enable dry contact can also be wired to switch the humidifier ON or OFF, this enable contact can be used either as a third safety control or as a way to control the humidifier ON and OFF, although **IER** steam humidifier is fully modulating.

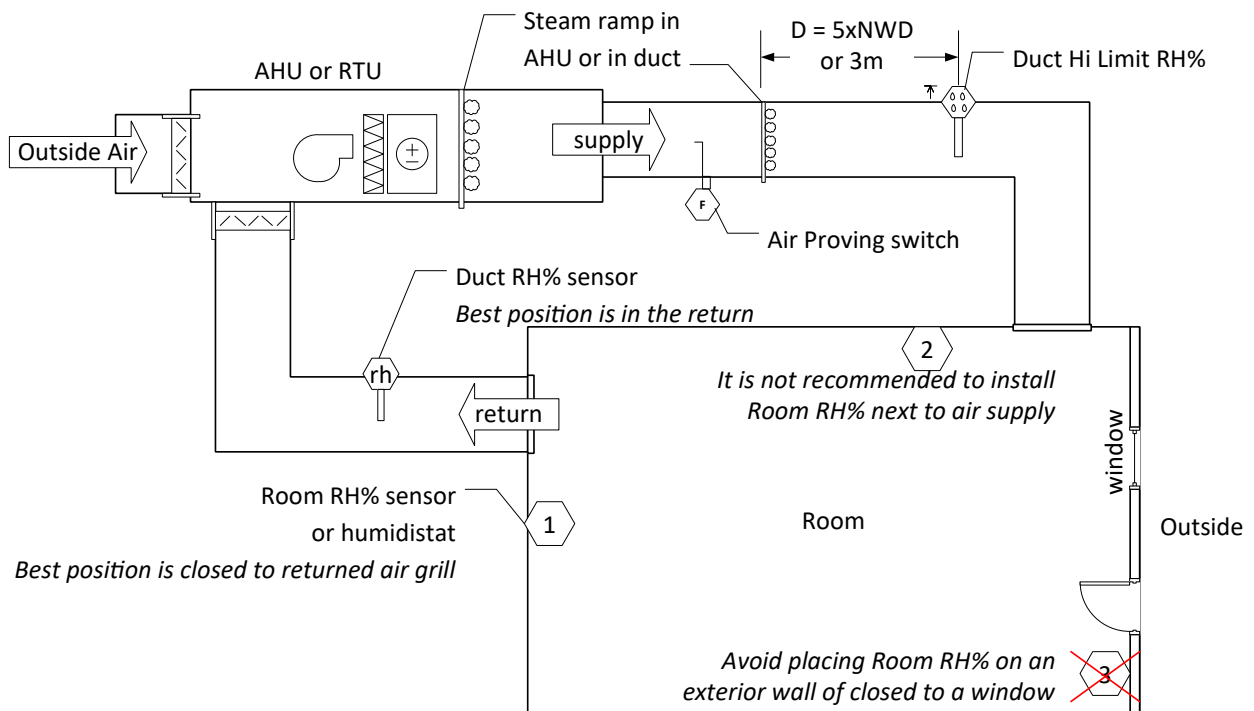

Figure 40, Controls placement recommendations

If Duct RH% sensor is used, it should be placed in return air duct

If Room RH% or humidistat is used, it should not be placed on an exterior wall, or next to supply air grill. Best position is closed to returned air grill.

Air proving switch should not be placed next of a fan or a plate that can vibrate, this would lead to wrong readings or early failure.

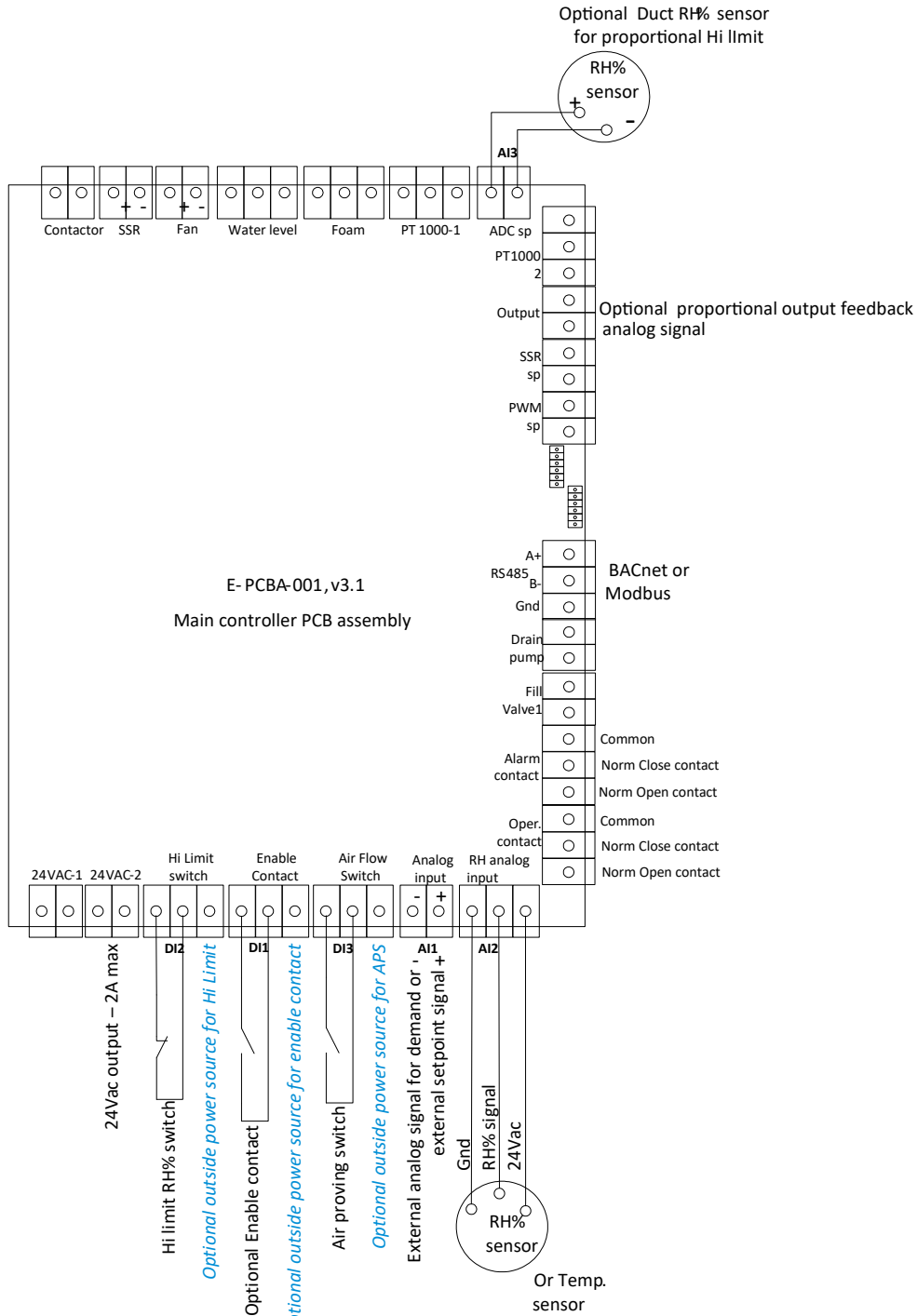

Figure 41, Control connections

Admissible control signal

Control	Admissible signals
External analog signal for demand	0-10Vdc, 2-10Vdc, 4-20mA
On-Off external signal	Dry contact
Proportional RH% or temperature sensor	0-10Vdc, 2-10Vdc, 4-20mA
Remote BAS control	Modbus (supplied standard) – refer to Modbus tables BACnet MS/TP (optional) – refer to BACnet PICS

Installation steps :

1. Ensure that the safety contact for Air proving switch and Hi limit humidistat are connected to the terminals 4 and 5.
2. Connect the applicable controls according to the above wiring diagram
3. Selection of control signal is done through set-up screens once the IER will be powered.

Verification before start-up

Warning

For safety and warranty reasons, Installation and service of this humidifier should be carried out by trained and qualified personnel.

Any work related to installation and service of this humidifier must comply with local code and regulation regarding safety and prevention of accidents.



Risk of electric shock.

Disconnect power supply before verification.



Risk of malfunction. Steam lines should not have any restriction or blockage that may cause a burst of pressure in the steam line.

Risk of flooding. In order to avoid any risk of flooding steamOvap recommends a Hi limit humidity switch installation in the air duct downstream of the steam distribution ramp.

Risk of freezing. Plan an anti-freeze system in case of installation in a location that would be exposed to outside conditions and susceptible of freezing.

Risk of malfunction. Do not block steam outlet(s).

Check list

- **Mounting**
 - Check mounting to verify that the **IER** is level and securely supported before filling with water.
- **Water supply**
 - Verify that all piping connections have been completed as recommended and that water pressure is available.
 - Once water shut off valve is open, verify for any possible leaks.
- **Drain**
 - Verify that all drain piping has been completed as recommended and that an open drain deported from **IER** is provided.
- **Steam**
 - Verify that all steam piping has been completed as recommended and that a slope of minimum 2° is provided.
 - Ensure that there is no sag or kink or any possible obstruction in the steam line, and condensate line.
- **Power supply**
 - Verify that power supply wires have been connected to main terminal and ensure that all wires are safely tightened. Ensure that an all pole disconnecting device with fuses is installed and easily accessible.
- **Control circuit**
 - Verify that safety controls such as air proving switch and Hi limit humidistat have been connected.
 - Verify that a control signal demand or RH% sensor is connected to the control terminals.

Once all above verification has been completed and found satisfactory you can powered up the **IER** steam Humidifier.

Configuration & Operation

Dashboard screen

Dashboard screen is also the main/home screen

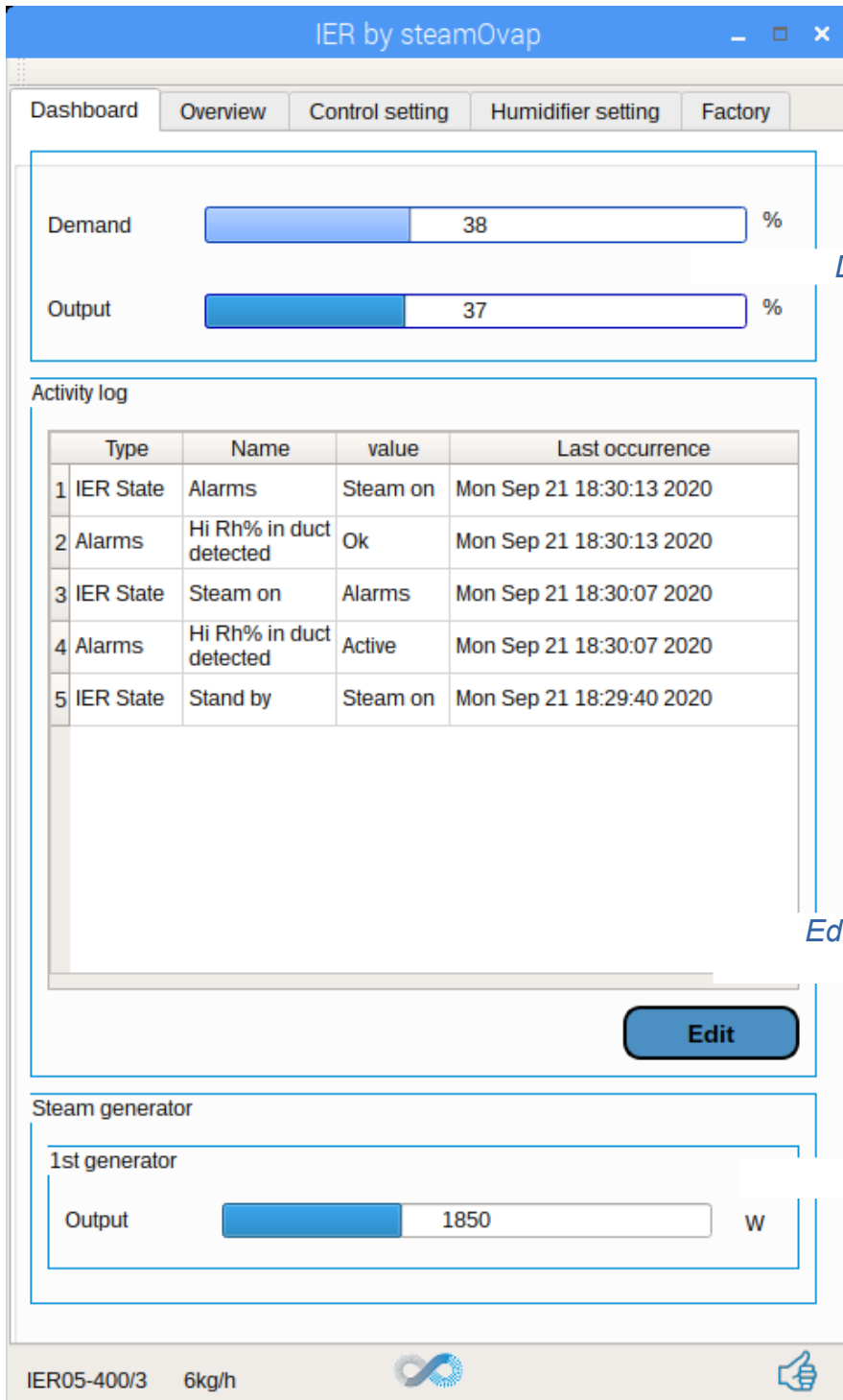

Demand & output in lb/h or %

Edit button allows to configurate Activity log

Output in power (Watt)

Figure 42, Dashboard screen

Status icon

Overview screen

Overview screen gives all information on internal sensors and control settings and allow ordering a drain for service

Drain for service

Generator 1 Start

Drain for service is initiated when start button is pushed

First generator	
IER State	Steam on
Water temperature	100 C
Water level	86 %
Room humidity	28 %
Enclosure Temperature	NA
Output	38%
Hours (last service)	0h

This section gives all info on internal sensors reading and humidifier operation

	Source	Range
Control	RH% demand	0-10Vdc
Setpoint	Internal (RH%/Temp)	0-10Vdc
Hi lim	On/Off demand	NA

Summary information on control connected to humidifier

IER05-400/3 6kg/h

Figure 43, overview screen

Icon status

An icon status located at the right hand side in the footer of the screen indicate the status of the IER



IER is OK and in operation or stand by.



critical alarm will stop operation of IER, if latched will need manual reset by service technician, otherwise it will auto reset when abnormal condition is over.



Alarm level 2, non-critical alarm will not stop operation of IER, auto reset as soon as default is over.



Communication between board computer and Main controller is altered.



Service is required.

IER states

The different possible states of the IER are:

- STANDBY_STATE,
IER is disable (see status of enable button in Control setting / control config).
- ARMED_STATE,
IER is ready to operate, waiting for humidity demand
- STEAM_ON_STATE,
IER is producing steam
- DRAINCYCLE_STATE,
IER is draining the cylinder
- ADD_WATER_STATE,
IER is adding water in the cylinder (while producing steam or not)
- PRE_HEAT_STATE,
If Preheat function is enable, the IER is heating water in the cylinder.
- ALARMS_STATE,
IER is on Alarm of level 1, a manual reset is required, go to Humidifier settings / Reset alarm.
- SERVICE_STATE,
User has ordered a drain for service, in this case **IER** will drain the cylinder, refill with fresh water in case the temperature inside cylinder is above 140°F [60°C] (if cooling function is enabled), and drain again.

Control Setting screen

Control setting screen allows user typically a control engineer to set signal and parameters to control the IER humidifier.

Access to this screen can be restricted with pass-code. In this case password is 3549

Pop up to enter password

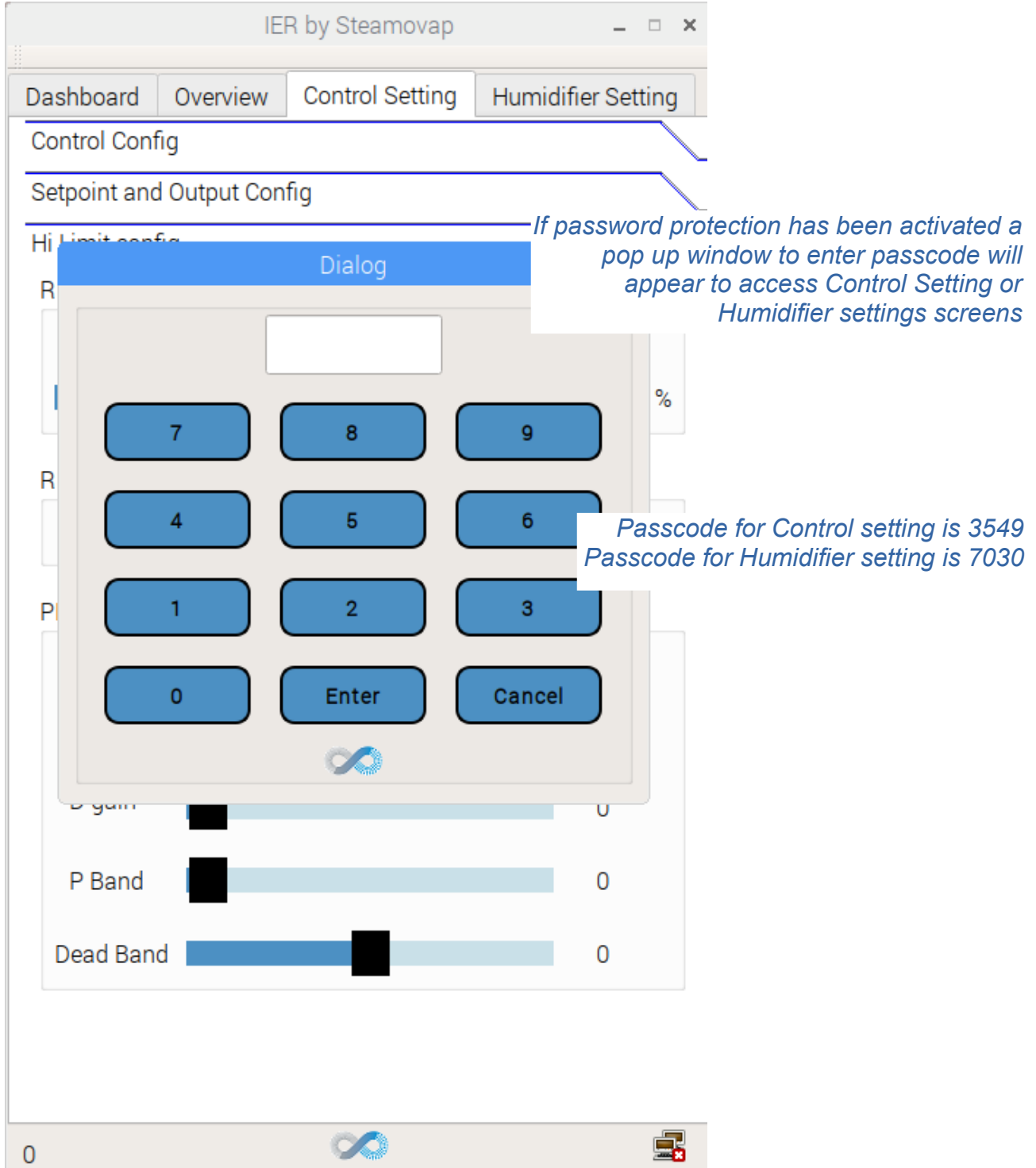

Figure 44, password screen

Control setting / control config

Control Setting menu is subdivided in 4 screens:

- Control Config
- Set point & output Config.
- Hi Limit Config.
- Scheduler

Select the control source from :
RH% demand
External dmd
RH% of Temp sensor
Remote

Select range for signal

Or select RH% (or Temp.) sensor signal range

If applicable, set the PID

You can put humidifier Off or On with Enable switch

Figure 45, Control setting/control config screen

Control setting / setpoint & output config

IER by steamOvap

Dashboard Overview **Control setting** Humidifier setting Factory

Control Config.

Setpoint and output Config.

Setpoint source

Internal

45 %

Setpoint signal range

0-10Vdc

Output signal range

0-10Vdc

Output capacity reduction

100 %

Disinfection Setpoint (Temp)

0 C

Disinfection Time

0 min

Hi lim Config.

Scheduler

IER05-400/3 6kg/h

Select the setpoint source from :
Internal
External
Remote

If internal, set the Setpoint with cursor

Or, if external, set the Setpoint signal range from
0-10vdc,
2-10Vdc,
4-20mA

Set output signal range (if used) from
0-10vdc,
2-10Vdc,
4-20mA

Steam output reduction,
If 5% = steam output reduced to 5% of total capacity

If disinfection mode has been selected, set disinfection temperature & time here

Figure 46, Control setting/set point config screen

Control setting / Hi Limit config

IER by steamOvap

Dashboard Overview **Control setting** Humidifier setting Factory

Control Config.

Setpoint and output Config.

Hi lim Config.

RH% Hi limit source

On/Off demand

0 %

RH% Hi limit signal range

0-10Vdc

PID Configuration

P gain 0

I gain 0

D gain

P Band

Dead band 0

Scheduler

IER05-400/3 6kg/h

Select RH% Hi Limit source from :
On/Off demand
External analog demand
Both

If internal, set the Setpoint with cursor

Or, if external, set the RH% Hi limit signal range from
0-10vdc,
2-10Vdc,
4-20mA

If applicable, set the PID

Recommended (default) setting is :
P gain : 60
I gain : 25
D gain : 20
P Band : 0
Dead band : 0

Figure 47, Control setting/Hi Limit config screen

Control setting / Scheduler

IER by steamOvap

Dashboard Overview **Control setting** Humidifier setting Factory

Control Config.

Setpoint and output Config.

Hi lim Config.

Scheduler

System date and time *Information on current Date & time of the internal clock*

Mon Sep 21 18:32:38 2020

Event

	Date	Time	Action	value
1	Tue Sep 22 2020	11:00:00	Setpoint change	62

Add

Delete

Scheduler can program events based on date and time

Event types are :

- On or Off*
- Setpoint change*
- Drain cycle*
- Service*

Event can be set for one or recurring occurrences

If recurring a frequency based on day and/or time should be set.

IER05-400/3 6kg/h

Figure 48, Control setting/Scheduler

Humidifier setting screen

Humidifier setting screen allows user (mechanical contractor) to set humidifier parameters. Access to this screen can be restricted with passcode. In this case passcode is 7030

Humidifier Setting menu is subdivided in 5 screens:

- Humidifier setting 1
- Humidifier setting 2
- BMS setting
- Main setting
- System information

Humidifier setting / setting 1

Reset alarms *Reset alarm allows to reset latched alarms*

Generator 1

Drain frequency *Drain frequency is to reduce mineral concentration in boiling water*

You can disable this function (if RO or pure water is used) ON OFF

Auto dilution 12 h *See our guideline below, if tap (city) water is used*

Inactivity drain *Inactivity drain is to flush cylinder when no demand*

You can disable this function ON OFF

72 h *If On, set the time with no demand before flushing cylinder*

Drain cooling *Drain cooling is to reduce temperature of wasted water when draining*

ON OFF

Service frequency *Service freq. Is the operation time period before to call for cleaning.*

610 h

Service auto off *If service Auto off is ON the humidifier will shut down when service is due*

ON OFF

Drain frequency guideline when tap (city) water is used

In order to avoid foaming, water contained in cylinder needs to be deconcentrated from time to time from its minerals dissolved content (TDS).

- Traditional way is to drain most of water from cylinder at a fixed freq. Time.
- If cursor is set on "Autodilution" (full left) EcoEnerSmart (patented) function is activated : humidifier will flush a small amount of water and bring equivalent of new water more frequently; saving energy & water. Autodilution frequency will auto-adapt in case foam will be detected.

Figure 49, Humidifier setting/setting 1 screen

Humidifier setting / setting 2

The screenshot shows a web-based control interface for a humidifier. At the top, there is a navigation bar with tabs for 'Dashboard', 'Overview', 'Control setting', 'Humidifier setting', and 'Factory'. Below this, the 'Humidifier setting 2' section is active. It contains several settings:

- Antifreeze option protection:** A text box explains that the antifreeze function will keep water inside the cylinder warm when no demand is present. A toggle switch is currently set to 'OFF'. An annotation states: "Activate Anti-freeze protection in case humidifier is installed in location with risk of freezing."
- Water temp sensor calibration:** A slider is positioned at the center, with a value of '+0 C' displayed.
- External fan (s):** A toggle switch is set to 'ON'. Below it, a slider is positioned at the left end, with a value of '0 s' displayed. An annotation states: "Activate Fan and set Off delay when a Space blower is connected".
- Water pre-heat:** A toggle switch is set to 'OFF'. Below it, a slider is positioned at the left end, with a value of '0 C' displayed. An annotation states: "Water pre-heat will reduce time delay to produce steam when there is a RH% demand".

At the bottom of the screen, there is a footer with the text 'IER05-400/3 6kg/h', a logo, and a thumbs-up icon. Below the screenshot, the caption reads: "Figure 50, Humidifier setting/setting 2 screen".

Humidifier setting / BMS setting

IER by steamOvap

Dashboard Overview Control setting **Humidifier setting** Factory

Humidifier setting 1

Humidifier setting 2

BMS setting *When BMS Override is ON, full control of the humidifier is remote through Modbus or BACnet connection*

BMS override OFF

BMS setting [Edit](#)

BMS overview *Edit button allows to set the BMS protocol & connexion settings as indicated in BMS overview table below*

Settings	
BMS type	BACnet MSTP
MODbus slave Add.	1
MODbus parity	0
MODbus baudrate	38400
BACnet MAC	2
BACnet instance	2

Main setting

System Informations



IER05-400/3 6kg/h  

Figure 51, Humidifier setting/BMS setting

Humidifier setting / BMS setting

IER by steamOvap

Dashboard Overview Control setting Humidifier setting Factory

Humidifier setting 1

Humidifier setting 2

BMS setting

Main setting

Control setting password *Activate passcode protection for Control setting menu*

Humidifier setting password *Activate passcode protection for Humidifier setting menu*

System date and time *Edit and set the internal clock date & time*

Mon Sep 21 18:32:48 2020 **Edit**

Units

Temperature Celsius

Demand output %

Language selection English

Select units from Celsius or Fahrenheit

Select units from % or lb/h or kg/h

Select language from English, French, Swedish, Spanish

System Informations

IER05-400/3 6kg/h

Figure 52, Humidifier setting/Main setting

Humidifier setting / System information

IER by steamOvap

Dashboard Overview Control setting **Humidifier setting** Factory

Humidifier setting 1

Humidifier setting 2

BMS setting

Main setting

System Informations

Software version info		SN:7777777	
User Interface	3.12	IER software version	3.14

Device Firmware Update *Allows for firmware update*

Caution : Do not use this function without our technical support **Update**

File Manager *Allows for events and data trending exportation*

Eject USB **Import**

Reset System *Allows to reset all settings to default (factory values)*

Caution : Do not use this function without technical support from steamOvap support team or representative **Reset**



IER05-400/3 6kg/h  

Figure 53, Humidifier setting/System information

List of alarms

In case of alarm, the status icon located at the right hand side in the bottom footer of the screen can be either:



Alarm level 1, critical alarm will stop operation of IER, if latched will need manual reset by service technician.



Alarm level 2, non-critical alarm will not stop operation of IER, auto reset as soon as default is over.

Alarm	Level	Description
Service needed	2	Servicing the cylinder is required latched if set as is by installer
Air Flow error	1	No air flow in the duct
Hi Rh% in duct detected	1	A duct Hi limit RH% sensor or switch is installed and has detected High humidity.
Enable Switch	1	Enable switch is off
High temperature Switch	1 latched	Hi limit safety switch located on top of the cylinder is open
Water level sensor def	1	Water level sensor is defective
Water level sensor error	1	Water level detected is abnormal
Water level too high	1	Water level is higher than expected
Water level too low	2	Water level is lower than expected
Water Temp. Sensor def	1 latched	Water temperature sensor is defective
Water Temp. Sensor error	1	Water temperature measured is abnormal
Foam detected	1	Foam is detected in the cylinder latched in case of repetition
Water inlet Low Flow	2	Fill or refill of cylinder is longer than expected
Water Feed Error	1	No water is supplied
Drain pump error	1	Drain pump is not able to empty cylinder
Unit not heating	2	IER not heating water
Electric supply	2	Low power
No control Connected	2	No signal received
Communication Status	2	Loss of communication between board computer and Main controller

Warranty

steamOvap technologies inc. (hereinafter referred to as **steamOvap**), warrant for a period of 3 years after installation, that steamOvap manufactured and assembled products are free from defects in material and workmanship; provided that a start-up report with no default has been done and signed by the authorized **steamOvap** local representative. Otherwise the warranty period is reduced to 18 months.

steamOvap's obligations and liabilities under this warranty are limited to furnishing replacement parts to the customer, F.O.B. **steamovap's** factory, providing the defective part(s) is returned freight prepaid by the customer. Parts used for repairs are warranted for the balance of the term of the warranty on the original product or 90 days, whichever is longer.

No liability whatsoever shall be attached to **steamOvap** until said products have been paid for in full and then said liability shall be limited to the original purchase price for the product. Any further warranty must be in writing, signed by an officer of **steamOvap**.

steamOvap makes no warranty and assumes no liability unless the equipment is installed in strict accordance with installation manual in effect at the date of purchase and by qualified and trained personnel and in accordance to local codes and regulations.

steamOvap makes no warranty and assumes no liability whatsoever for consequential damage or damage resulting directly from misapplication, incorrect sizing or lack of proper maintenance of the equipment.

steamOvap retains the right to change the design, specification and performance criteria of its products without notice or obligation.

In case of litigation or dispute arising, all parties agree that the exclusive venue for any litigation shall be vested with a court of competent jurisdiction located in the Judicial District of Montreal, Quebec, Canada.



2021 © steamOvap technologies inc.
1490 Mazurette
Montreal, Qc, H4N 1H2
Canada

Tel.: +1-844-357-4477
info@steamOvap.com
www.steamOvap.com

Information contained in this manual is subject to change without notice.
To obtain the latest technical information visit our website at www.steamOvap.com